

CODA
C O D A A U D I O



CATALOGUE

Coda Audio – European designer and manufacturer of high quality speaker systems

Coda Audio is a leading designer and manufacturer of the highest quality pro-audio loudspeaker systems. We believe that developing a good loudspeaker system starts with designing the correct drivers. Due to our unique, patented driver design, Coda Audio loudspeaker systems are extremely transparent and detailed, providing outstanding dynamic results. Coda Audio's advanced transducer technology offers significant advantage over conventional drivers in precision and reliability. Almost all critical parts of the cabinets and the drivers are produced in Europe, in our own factories, to ensure exacting and extensive control of all results. Voice coil winding, diaphragm forming, CNC machining is all undertaken internally by highly qualified professionals.

Durability and reliability are most important in all professional applications. Rugged construction, featuring Baltic birch plywood for the cabinets and a very intensive testing process ensure reliability and consistency. The fact that our entire manufacturing process takes place in our own factories has produced a substantial reduction in cost and a high degree of flexibility and efficiency. The wide product range is designed to offer excellent quality solutions which are able to satisfy the most discerning and complex of professional sound reinforcement applications. Coda Audio is represented via a global network of international distributors.

We believe that the best way to get to know us better is by listening to our loudspeakers because:

HEARING IS BELIEVING



Coda Audio
Boulevard der EU 6
30539 Hannover, Expo Park
Germany
Phone: +49 (0)511- 866 558 88
Fax: +49 (0)511- 866 558 87
E-Mail: contact@codaaudio.com
Website: www.codaaudio.com



Content

AIRLINE LA- / Sensor controlled Subwoofer-Series		CoRAY-Series	
AIRLINE LA-Series Introduction	4	CoRAY4 Introduction	41
AIRLINE LA12	4	CoRAY4 / CoRAY4L	42
Sensor controlled Subwoofers Introduction	6	CoRAY4i / CoRAY4Li	44
SC8 / SC8F	7		
AIRLINE LA12-B	8	D-Series	
ViRAY	10	D-Series Introduction	46
SCV-F	15	D5-Tube / D5-Ceiling	47
AIRLINE LA8	16	D5-Cube	48
AIRLINE LA8-SUB	17	D8	49
SCP / SCP-F	18	D12	50
SC4	19	D20	51
RC-Racks Introduction	20		
Touring Racks RC20T / RC40T	21	K-Series	
LA5A	22	K-Series Introduction	52
LA5A-SUB	23	K4 / K5	53
LA4	24		
LA4-SUB	25	D-Core	
EASE Focus II	26	PW12A	54
		D-Core2	55
CUE-Series		PW15A-Pro	56
CUE-Series Introduction	27	D-Core5	57
CUE ONE	28	PW18A-Pro	58
CUE TWO	29	D-Core8	59
CUE FOUR	30		
		PW-Series	
G-Series		PW-Series Introduction	60
G-Series Introduction	31	PW112 / PW112A	61
G308 / G308F	33	PW115 / PW115A	62
G512	34	PW118 / PW118A	63
G515	35	PW215 / PW215A	64
G712	36	PW418v ² / PW418Av ²	65
G715	37		
G-SUB-Series Introduction	38	Electronics	
G15-SUB	39	DNC260 / DNC260N	66
G18-SUB	40	C3	67
		C5	69



AIRLINE LA-Series

Our commitment to advanced technology.

AIRLINE LA-Series line array systems present our commitment to advanced technology offering high fidelity sound, even wide-dispersion characteristics and extreme high spl optimized for use in professional touring applications such as open air concerts, festivals and arenas as well as sound installations in stadiums, houses of worship, large clubs, theatres and musicals.

At the heart of the Coda Audio AIRLINE LA-Series Line-Arrays is the unique 4-inch planar wave driver. Coda Audio developed a unique driver technology to radiate a coherent planar wave front from a rectangular piston without internal diffraction for superior dispersion control and high fidelity sound. The driver contains a high energy neodymium magnet system and a unique annular ring diaphragm. The ring diaphragm works similar as a wound 140 mm long ribbon diaphragm providing linear frequency response up to 20 kHz.

The advanced driver design allows perfect acoustical coupling of individual units to create a virtually continuous and truly coherent line source.



The AIRLINE LA12 is a 3-way symmetrical high output line array module, designed for large venues where high fidelity sound and outstanding intelligibility is required.

State-of-the-art drivers

Low: The cabinet contains two 12" neodymium ultra low distortion cone drivers covering the 50 Hz – 400 Hz range. The double 12" long excursion drivers contain high flux linear motors with triple demodulation rings for ultra low distortion and increased power handling.

Mid: Our goal was to generate very high resolution and high dynamic range. To achieve this we developed a special transducer which works in the mid range as a pure piston without the breaking up modes typical for direct radiating small cone drivers. Another aim was to increase the sensitivity and get outstanding headroom in the very important middle range. The AIRLINE LA12 contains four 3.5" voice coil neodymium mid range drivers with unique ring diaphragms covering the 350 Hz – 1700 Hz range. Loaded to advanced hyperbolic lenses they achieve very high sensitivity of 116 dB 1 W / 1 m above 300 Hz. This means that the drivers need less power to produce enormous high spl and work almost at less than 10% of their nominal power handling. Therefore the ability to reproduce peaks is unique and is practically only limited by the electronics. This patented design is a result of extensive dedicated research and development resulting in near zero power compression, dramatic improvement in dynamic response, clarity and transparency.

High: The three 4" HF planar wave drivers contain unique annular ring diaphragms to radiate a coherent planar

wavefront without internal diffraction. This distinctive technology allows perfect acoustical coupling for superior dispersion control and high fidelity sound.

Coherent wavefront

The tri-axial V-arrangement of the low, mid and high frequency drivers ensures coherent coupling between all components. The high frequency planar wave drivers are mounted in the middle, close to the mid-range hyperbolic lenses. The twin 12" drivers are optimally placed to provide a constant horizontal directivity above 200 Hz. This arrangement combines the energy produced from all 9 transducers to perform as a single source achieving a coherent and uniform wavefront.

Application:

The modules are designed to be used in multiples with a minimum configuration of six. Up to 24 units can be arrayed to achieve extreme high levels needed for the largest venues. The use of SC8 / SC8F subwoofers increases the low frequency response. The integrated rigging system allows quick and easy flying or ground stacking. Arrays may be built straight or curved in various angles to obtain the desired vertical coverage. The Coda EASE Focus simulation software allows you to calculate the perfect setup for every application. Designed for large scale touring and installation applications the AIRLINE LA12 is perfectly suited for open air, stadiums and large theatres where outstanding output capability and low power compression are needed. Applications include sports venues, stadiums, large theatres and large houses of worship, touring and open air festivals.

AIRLINE LA12

AIRLINE LA12

3-way symmetrical high output
line array system

- Three Coda Audio 4" neodymium planar wave drivers (patent pending)
- Four Coda Audio 3.5" coil neodymium mid range drivers
- Twin Coda Audio 12" neodymium ultra low distortion woofers
- 100° horizontal coverage
- Variable curving 0° - 8°
- Outstanding SPL capability at very low power compression
- Highest output to size ratio
- Highest output to weight ratio
- Superior sound
- Integrated rigging system for flown or ground-stacked arrays

- System components: Coda Audio System Racks, SC8, AIRLINE LA12-B

TECHNICAL SPECIFICATIONS LA12

Type:	3-way high output line array module
Application:	Minimum 4, maximum 24 units line array
Frequency response:	50 Hz – 20 kHz (-3dB)
Power handling:	
Low AES/Peak:	2000 / 8000 W
Mid AES/Peak:	600 / 6000 W
High AES/Peak:	240 / 2400 W
Sensitivity Low 1 W / 1m:	98 dB
Sensitivity Mid 1 W / 1 m:	116 dB
Sensitivity High 1 W / 1 m:	118 dB
Max. SPL peak Low:	137 dB
Max. SPL peak Mid:	153 dB
Max. SPL peak High:	152 dB
Dispersion Horizontal:	100°
Vertical:	Array dependent, 0° - 8° in 1° steps
Components:	
Low frequency:	2 x 12" neodymium woofers 4" voice coil, 1000 W (AES) each
Mid frequency:	4 x 2" neodymium drivers 3.5" voice coil, 150 W (AES) each
High frequency:	3 x 4" neodymium planar wave drivers 1.75" voice coil, 80 W (AES) each
Crossover point:	350 Hz, 1.600 Hz active
Input connectors:	Neutrik™ NL8MPPR-BAG
Patch cable:	Included
Nominal impedance:	LF1: 16 Ohm (+1 / -1) LF2: 16 Ohm (+2 / -2) MF: 16 Ohm (+3 / -3) HF: 24 Ohm (+4 / -4)
Enclosure shape:	Horizontal trapezoid 2 x 4°
Enclosure material:	Baltic birch plywood
Finish:	Black Polyurea coating (water resistant)
Flying Hardware:	Included
Dimensions:	1108 x 339 x 495 mm
Net weight:	67 kg

SYSTEM PERFORMANCE

Array	Horizontal Coverage	Vertical Coverage	Maximum Peak Output
1 x LA12	100°	-	137 dB
2 x LA12	100°	0° - 8°	143 dB
4 x LA12	100°	0° - 32°	149 dB
8 x LA12	100°	0° - 64°	155 dB

ACCESSORIES

FR120	Compact frame for flying up to 24 units of AIRLINE LA12 with safety factor 1:10
FR122	Compact frame for flying or ground stacking AIRLINE LA12 and/or SC8F in cardio mode
FR002	Upgrade kit FR120 to FR122
FR128	Alteration frame kit for FR8, for flying AIRLINE LA8 under AIRLINE LA12
DOL LA12	Transport and rigging dolly for single AIRLINE LA12
DOT LA12	Transport and rigging dolly for up to 4 units AIRLINE LA12 incl. Lid
KIT 12F	Adaptor kit for fixing FR120 / FR122 frame to DOT LA12 dolly
EXBAR 12	Extension bar for FR120 / FR122 frame
CO LA12x4	Protection cover for 4x AIRLINE LA12
CAL8SP-20	8-pole loudspeaker cable, 8x4 mm, 20 m

RIGGING POSSIBILITIES

AIRLINE LA12 + LA12-B

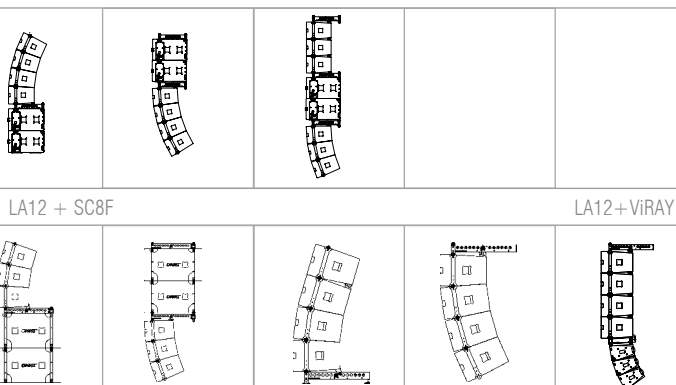

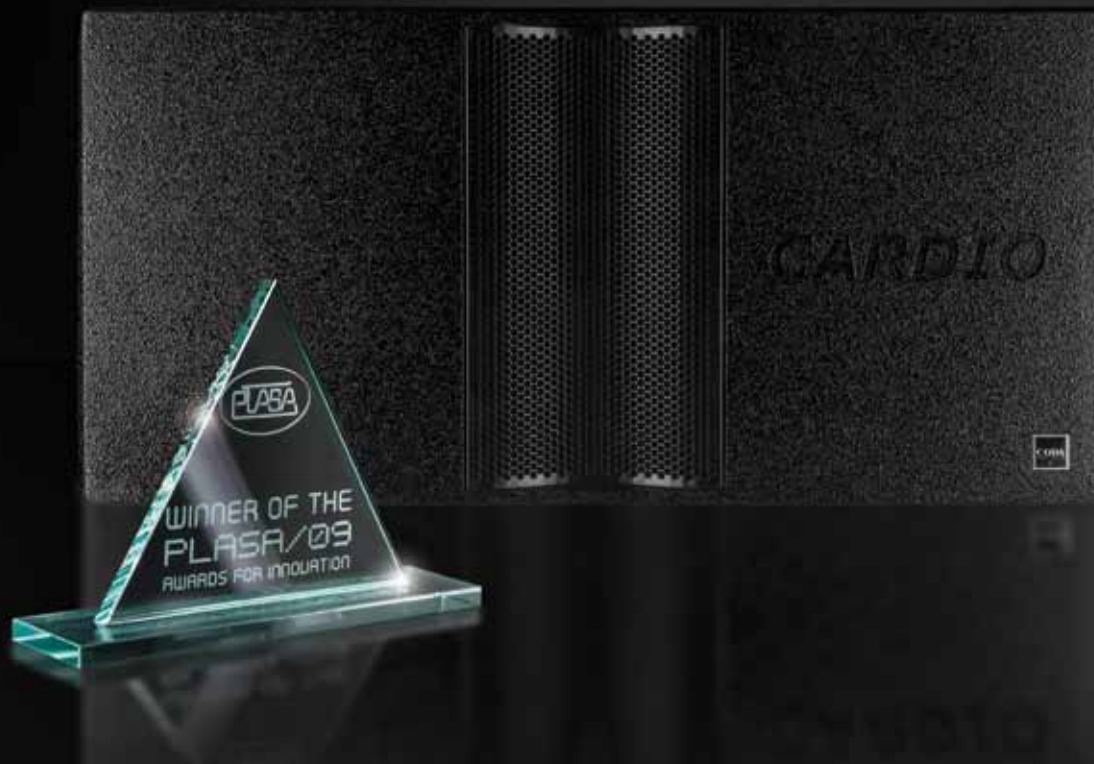

Sensor controlled subwoofers

The Feedback loop controlled subwoofers have clear advantages over conventional subwoofers when it comes to sonic performance, output and size.

The advanced design aligns several new technologies for outstanding performance.

Key technologies

- Award winning sensor controlled technology
- Feedback loop control – ultra low distortion, very extended and controlled response
- Long excursion 18" woofers with integrated velocity sensor

What is the Velocity Feedback Loop Comparator?

The specially designed 18" driver includes a built in "velocity sensor" that measure precisely the movement of the voice coil. The "velocity sensor" sends information to the Comparator about velocity, excursion and speed of the voice coil (using XLR cable).

The comparator unit of the Coda comparator amplifiers compares the original input signal to the movement measurement from the "velocity sensor" and adjusts the amplifier driving voltage and/or current so that the diaphragm moves the way it should move. This compensates in real time for the non linearity of the speaker/cabinet.

Reduced group delay

This is a big issue that is most often overlooked in conventional designs. The feedback comparator technology offers

great advantages in the time domain. In fact the upper bass and the very low frequency are time aligned which means they are reproduced at the same time resulting in extremely accurate and musical bass reproduction.

Transducers

The Sensor controlled subwoofers are equipped with extremely long excursion 18" neodymium ultra low distortion woofers with integrated velocity sensors that measure, compare and control cone movements. The neodymium motor delivers extreme high magnetic flux for increased efficiency. The 4" voice coil is 50 mm high, ensuring ultra linear excursion of 40 mm / pp at consistent magnetic force. State of the art carbon-fiber cone ensure maximum stiffness and low moving mass. Three aluminum shorting rings reduce inter-modulation distortion; minimize induction variation while reducing thermal compression. This design reduces dramatically the distortion of a typical subwoofer at longer excursion levels, and improves the overall sound quality and performance characteristics of the cabinet. The sensor is in fact an additional voice coil connected to the loudspeakers voice coil in a high precision, magnetically shielded system.

Electronics and Cabling

The Coda Audio comparator amplifiers provide integrated power and feedback loop control solution for the Sensor controlled subwoofers. The comparator's electronic circuit loop measures the voice coil excursion of the driver and corrects the signal, significantly decreasing distortion. The unit is set for flat frequency response down to 25 Hz (-6 dB).



SC8 / SC8F

SC8F

Sensor controlled subwoofer
with versatile pattern control



- 4 x Coda Audio 18" extreme high output subwoofer
- Velocity sensors for feedback loop control
- Extended frequency range down to 20Hz (-6 dB), 25 Hz (-3dB)
- Ultra low distortion

- Fast transient response, the upper bass and the ultra low frequency are time aligned
- Cardio, Hypercardio or Omni directional mode
- Optional rigging hardware for flown or ground-stacked arrays (SC8F)
- Reduced truck space for reduced labor and transport costs

- System components: Coda Audio System Racks, AIRLINE LA12 AIRLINE LA8

The SC8 subwoofer

Description: Sensor controlled subwoofer with versatile directional characteristic incorporating four 18" long excursion woofers in a sealed enclosure.

SC8 key technologies:

The advanced design aligns several new technologies for outstanding performance.

Feedback loop control – ultra low distortion

Sealed enclosure – superior transient and phase response
Versatile pattern control – Cardio or Omni mode in one cabinet. Long excursion drivers with integrated velocity sensor

Main advantages of the Feedback Loop Comparator:

Total Harmonic Distortion is reduced significantly
About 20 dB less distortion at 20 Hz compared to the cabinet without velocity sensor.

Extended Frequency response

The SC8 subwoofer provides perfectly flat response down to 25 Hz and very high output and low distortion. No high pass filters or equalizers are required.

Reduced group delay

The upper bass and the very low frequency are time aligned resulting in extremely accurate and musical bass reproduction.

Directivity

The SC8 can be configured for different polar patterns: Cardio / Hypercardio or Omni directional when the cabinet is rotated at 90°.

Applications:

The SC8 subwoofer is perfect suited not only as a sub-extension for AIRLINE LA12, but for general use in arenas, houses of worship, theatres, clubs and open air.

TECHNICAL SPECIFICATIONS SC8 / SC8F

Type:	Sensor controlled Cardio / Omni subwoofer
Application:	High output subwoofer
Frequency response:	20 Hz (-6 dB), 25 Hz (-3 dB) to 125 Hz
Power handling (AES / Peak):	6000 W / 24000 W
Sensitivity 1 W / 1m:*	106 dB @ 50 Hz
Maximum output peak:**	150 dB
Components:	4 x 18" neodymium ultra low distortion woofers 4" (101.6 mm) voice coil, 1500 W (AES) each
Front:	2 x 18"
Rear:	2 x 18"
Nominal impedance:	Front: 4 Ohm +-1, Rear: 4 Ohm +-1
Input connectors:	2 x Neutrik™ NL4MP
Velocity sensors output:	1 x Neutrik™ NC5FDL1
Suspension:	optional flying hardware: SC8F (compatible to AIRLINE LA12 Frame)
Enclosure material:	Baltic birch
Finish:	Black Polyurea coating (water resistant)
Dimensions:	1108 x 540 x 982 mm
Net weight SC8:	122 kg
Net weight SC8F:	135 kg

* Half-space loading

** Measured with pink noise 6 dB crest factor

ACCESSORIES

FR122	Compact frame for flying or ground stacking AIRLINE LA12 and/or SC8F in cardio mode
FR002	Upgrade kit FR120 to FR122
DOT SC8	Transport dolly for up to 3 units SC8 / SC8F
CAH SC-10	Hybrid speaker and sensor system cable for SC subwoofers, 10 m
CAH SC-20	Hybrid speaker and sensor system cable for SC subwoofers, 20 m
CO SC8	Protection cover for single SC8 / SC8F
CO SC8x2	Protection cover for 2x SC8 / SC8F

AIRLINE LA12-B



AIRLINE LA12-B

Sensor controlled Bass Extension for AIRLINE LA12

- Increases the long throw capability of AIRLINE LA12
- Enhances the systems low frequency headroom
- Overlaps both the low range of LA12 and the SC8 reducing the need of additional subs
- Provides 15" sonic signature
- Reduces investment cost
- Long excursion 15" drivers with integrated velocity sensor for feedback loop control
- Extended frequency range 28 - 200Hz (-6 dB)
- Ultra low distortion
- Fast transient response; time aligned upper & ultra low frequencies
- Integrated rigging system for flown or ground-stacked arrays with AIRLINE LA12
- System Integration with the LINUS racks

- System components: AIRLINE LA12, SC8, SCP, LINUS10, LINUS8

Technology

The AIRLINE LA12-B employs Coda Audio's award winning sensor controlled technology. Combining closed feedback-loop control with large, low noise laminar flow ports, the LA12-B offers increased output and well controlled response.

Sensor controlled technology surpasses conventional subwoofer designs by offering measurable and clearly audible advantages in the impulse response, group delay, waterfall and the distortion domain. In fact the range 40 - 200 Hz is time aligned while the group delay increase slightly in the range 28 - 35 Hz. The reduced group delay results in extremely accurate and musical bass reproduction. The sound quality is far in advance of conventional port loaded systems.

Description

The AIRLINE LA12-B is NOT a subwoofer, it is a sensor controlled bass extension system operating in the range 28 - 200 Hz which overlaps both the low range of AIRLINE LA12 and the SC8 subwoofer providing essential more energy and control in the lower range of the system. Incorporating dual 15" drivers in a compact, vented enclosure it provides a distinctive 15" signature punch to the system.

The drivers contain an integrated velocity sensor that measures the diaphragm movement in real time, compares it with the input audio signal and adjusts the amplifier driving voltage and / or current, correcting any driver inaccuracy. It is a self-optimizing, closed feedback-loop in which the driver confirms precisely the power it needs to accurately

reproduce the original audio signal. The key advantage is a very extended and controlled response. Any distortion produced by the driver or the enclosure is instantly corrected by the feedback.

Transducers

The AIRLINE LA12-B is equipped with two extremely long excursion 15" neodymium ultra low distortion drivers with integrated velocity sensor that measures, compares and controls cone movements. The neodymium motor delivers extreme high magnetic flux for increased efficiency. The 4" voice coil is 36 mm high, ensuring ultra linear excursion of 26 mm / pp at consistent magnetic force. State of the art carbon-fiber cones ensure maximum stiffness and low moving mass. Three aluminum shorting rings reduce inter-modulation distortion; minimize induction variation while reducing thermal compression. This design dramatically reduces the distortion of a typical subwoofer at longer excursion levels, and improves the overall sound quality and performance characteristics of the cabinet. The sensor is in fact an additional voice coil connected to the loudspeakers voice coil in a high precision, magnetically shielded system.

System Solution

The AIRLINE LA12-B is designed to work exclusively with dedicated Coda Audio LINUS racks as an integrated solution for DSP and sensor control, amplification, network remote control and diagnostic.

The integrated solution ensures optimal performance and protection.

TECHNICAL SPECIFICATIONS AIRLINE LA12-B

Type:	Sensor controlled bass extension
Application:	Bass Extension for LA12
Frequency response:	28 - 200 Hz(-6 dB)
Power handling (AES / peak):	2500 W / 10000 W
Sensitivity 1 W / 1 m:*	103 dB
Maximum output peak:**	143 dB
Components:	2 x 15" neodymium ultra low distortion woofers 4" (101.6 mm) voice coil, 1250 W (AES) each
Nominal impedance:	4 Ohm, +1 / -1
Cabinets per channel:	1- 2x (LINUS10)
Input connectors:	2x Neutrik™ NL4MP (rear) + 1x Neutrik™ NL4MP (front)
Velocity sensors output:	Neutrik™ NC3MAV (rear) + Neutrik™ NC3MAV (front)
Suspension:	allows curving (0°, 2°, 5°)
Enclosure material:	Baltic birch
Finish:	Black polyurea coating (water resistant)
Dimensions:	111x 420 x 680 mm
Net weight:	72 kg
* Half-space loading	
** Measured with pink noise 6 dB crest factor	

Applications

AIRLINE LA12-B flown on the top of AIRLINE LA12 array (28 - 200 Hz) – increases the array length and enlarges the system's long throw capability

AIRLINE LA12-B flown beside the AIRLINE LA12 array (28 - 100 Hz) optimizes the system's horizontal directivity

AIRLINE LA12-B in array between AIRLINE LA12 cabinets (28 - 200 Hz) avoids balcony reflections

AIRLINE LA12-B ground-stack with AIRLINE LA12 (28 - 200 Hz) – compact and powerful solution for smaller venues

Options

Standard RAL colours and weather protection options are available on request.

ACCESSORIES

Frame
 Front dolly (single cabinet)
 Transport dolly (4x LA12-BE)
 Protection cover for single cabinet
 Protection cover for 4x LA12-BE
 Hybrid cable 10 m, 20 m
 Link cable 0.7m

RIGGING POSSIBILITIES

LA12 + LA12-B

LA12-B



ViRAY



ViRAY

with DDP Dual Diaphragm
Planar-wave-driver Technology

- Unique 8" coaxial mid/high planar wave driver
- Dual 8" neodymium ultra low distortion cone drivers
- ViCOUPLER unites all transducers to perform as a single source
- High power handling of 600 W
- Variable horizontal coverage of 120° or 80° or 100° asymmetrical (40°+60°)
- Vertical curving 0° to 10° variable in 1° steps
- Superior sound
- Integrated rigging system for flown or ground stacked arrays
- Multiplex enclosure with Polyurea coating for extreme durability and water protection
- Subwoofer extension with the SCV-F
- System integration with Coda system racks

■ System components: Coda Audio System Racks, SCV-F

Whether it's for live touring applications or high-end fixed installations, ViRAY has been created to surpass and excite the needs of both user and listener in equal measure.

Introducing "ViRAY" Coda Audio's new compact 3-way symmetrical line array system with DDP technology.

As with all Coda Audio products, the design concept of a new product always start with the key components. ViRAY is no different. ViRAY incorporates all new DDP (Dual Diaphragm Planar-wave-driver Technology), the purpose-built 8" coaxial mid/high planar wave driver sits at the heart of the system.



The DDP driver is a 2-way coaxial system employing two concentric annular ring diaphragms. Each driver covers a smaller frequency range for increased power handling, high dynamic and extremely low distortion.

The larger annular midrange diaphragm covers the frequency range 600 - 6.500 Hz with a smooth, linear response. The extended diaphragm excursion of max. +/- 0,8 mm results in high output and increased power handling up to 1300 W peak.



The ultra light annular diaphragm for the high range offers exceptional transient response with very high efficiency from 6 to 22 kHz.

This distinctive new transducer was engineered to radiate a true coherent planar wave front from a rectangular piston without internal diffraction for superior dispersion control and high fidelity sound.

The patented design is a result of extensive, dedicated research and development providing dramatic improvement in dynamic response, clarity and transparency.

ViCOUPLER

All ViRAY drivers are loaded to a common ViCOUPLER which combines the energy produced from all transducers to perform as a single source, without phase destruction achieving a coherent and uniform wavefront. In fact the ViCOUPLER determines the horizontal on-axis and off-axis frequency response.

The ViCOUPLER technology integrates 3 main functions:

- Waveguide for the Mid/High Planar-wave-driver
- Large plane screen panel to avoid backwards reflections
- Phase plug for the 8" drivers for optimized loading

The ViCOUPLER unites all elements to form a complete entity with complete balance.

In conventional design a backward sound wave from the mid/high range reflects to the cone onto the low frequency drivers. The interference between the direct radiating and reflected waves produce comb filter response.

The ViCOUPLER ensures that sound is reflected in a coherent manner because the dimension of the reflective surface is large compared to the wavelength.

In fact a ViCOUPLER loaded array performs as a single waveguide mounted in a large, flat baffle (screen) without diffractions. When sound waves from the mid/high range gather onto the flat surface, it generates a coherent sound field providing uniform power response and directivity control over a wide frequency range.



Conventional design



ViRAY with ViCOUPLER

Phase-Plug-Loaded cone drivers

Precision phase plugs are integrated into the ViCOUPLER to ensure acoustically coherent coupling of the low range

providing perfectly consistent coverage down to 350Hz. This optimizes the horizontal directivity and maximizes the system efficiency.



Horizontal Dispersion

To maximise precise coverage, and therefore maximize application results, user selectable horizontal coverage of 120° / 80° or asymmetrical 100° (60°+ 40°) or (40°+ 60°)

are available, allowing for very accurate audience coverage, reduced possibility of reflections, all resulting in outstanding system intelligibility.

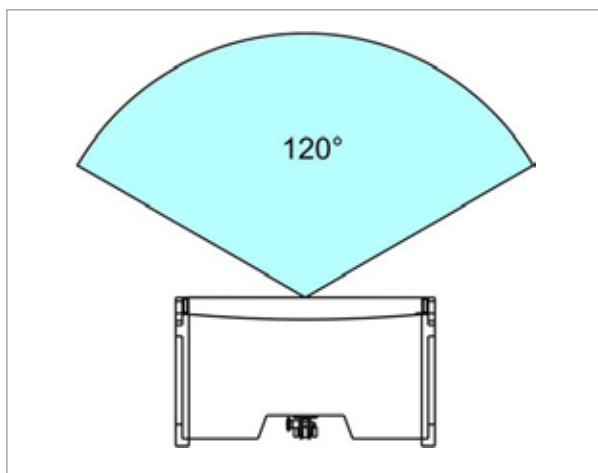

120° Horizontal Coverage

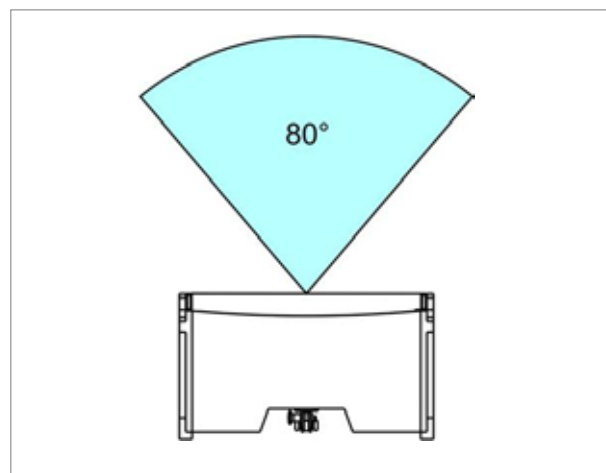

80° Horizontal Coverage

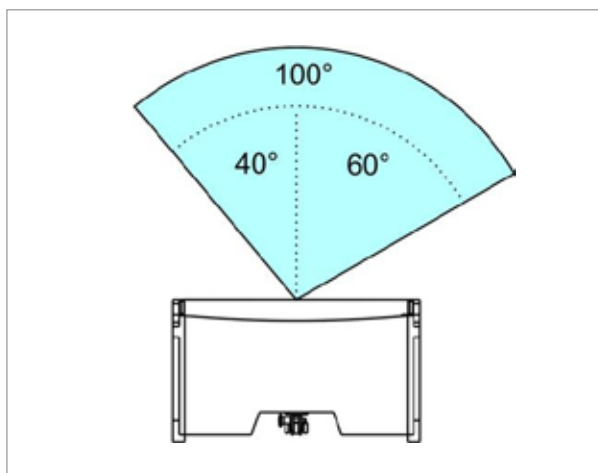

100° Horizontal Coverage

ViRAY's vertical coverage is array dependent from 0° to 10° in 1° steps. The system design allows for a vast increase in ground stack configurations as well as in flown arrays. ViRAY frequency response is from 55Hz to 22kHz. For extended Sub response the SCV-F Subwoofer, which utilizes Coda Audio's award winning Sensor Control technology, turns the two elements into one remarkable system. The SCV-F can be flown in curved arrays allowing full

system flown applications to be completely coherent in all respects. SCV-F may be used in Omni or Cardioid formats. The ViRAY is designed to work exclusively with dedicated Coda Audio RC racks as an integrated solution for DSP control, amplification, network remote control and diagnostic. The integrated solution ensures optimal performance and protection.

TECHNICAL SPECIFICATIONS ViRAY	
Type:	Compact 3-way Bi-amplified line array module
Application:	Minimal 1, maximal 24 units line array
Frequency response:	55 Hz - 22 kHz (-3 dB)
Power handling:	
Low AES / peak:	600 / 2400 W
Mid AES / peak:	150 / 1300 W
High AES / peak:	80 / 400 W
Sensitivity low 1 W / 1 m:	99 dB
Sensitivity mid/hi 1 W/1m:	112 dB
Max. SPL peak low (+6dB):	133 dB
Max. SPL peak mid/high (+6dB):	142 dB
Dispersion horizontal:	120°, 80° or 100° (60° + 40° or 40° + 60°)
Vertical:	Array dependent, 0°-10° in 1°-steps
Components:	
Low frequency:	2x 8" neodymium, water resistant cones 2" (50.8 mm) voice coil, 300 W (AES) each
Mid/High frequency:	8" coaxial neodymium Planar-wave-driver
Mid:	3.5" (90 mm) voice coil, 150 W (AES)
Hi:	1.75" (44.4 mm) voice coil, 80 W (AES)
Crossover point:	600 Hz Active, 6.300 Hz Passive
Input connectors:	2 x Neutrik™ NL4
Nominal impedance:	LF: 16 Ω (1+/-1-) MF/HF: 16 Ω (2+/-2-)
Enclosure shape:	Horizontal trapezoid 2x 5°
Enclosure material:	Baltic birch
Finish:	Black polyurea coating (water resistant)
Flying hardware:	Integrated
Dimensions (WxHxD):	674x242x362 mm
Net weight:	25.5 Kg

Application

Designed for medium size touring and installation applications the ViRAY is perfectly suited for theatres, clubs, houses of worship, corporate events and touring. Dedicated hardware allows the ViRAY to be used as a down-fill for AIRLINE LA12, and as a ground stack or in-fill system in its own right.

ACCESSORIES ViRAY

FR-VR	Heavy duty frame for flying or ground stacking ViRAY and SCVF
EXBAR-VR	Extension bar for FR-VR frame
TILT-VR	Tilting legs for ground stacking ViRAY/SCVF on FR-VR
DOW-VR-12	Down fill ViRAY under LA12
LP-VR	Laser plate for FR-VR frame
VGA	Groundstack adapter for ViRAY and SCVF
SH-VR	Shackle for FR-VR
FC-VR	Flight case for 4x ViRAY

RIGGING POSSIBILITIES ViRAY + SCV-F

SYSTEM PERFORMANCE			
Array	Horizontal Coverage	Vertical Coverage	Peak Output (+6dB)
1 Enclosure	120° or 80°	12°	133 dB
2 Enclosures	120° or 80°	0 - 10° adjustable	139 dB
4 Enclosures	120° or 80°	0 - 40° adjustable	145 dB
8 Enclosures	120° or 80°	0 - 80° adjustable	151 dB

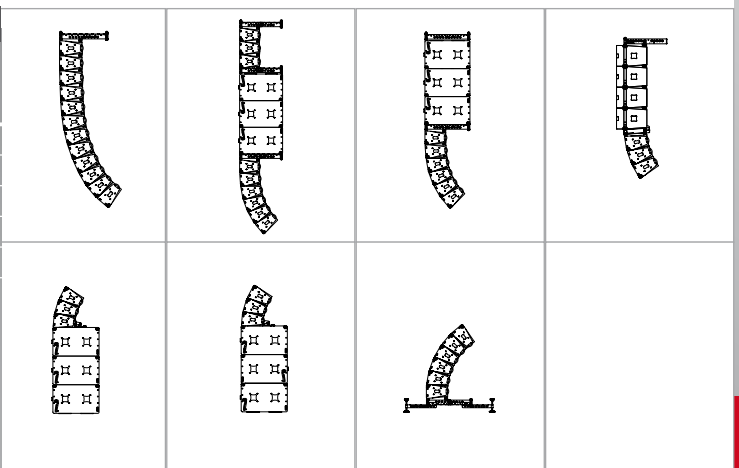

SCV-F



SCV-F

Compact 18" sensor controlled subwoofer

- Flyable or ground stackable in cardio or omni configurations
- Rigging is compatible to ViRAY
- Subwoofer arrays can be curved for perfect time alignment with ViRAY
- Coda amplifier comparators provide integrated power and feedback loop control solution
- System components: Coda Audio System Racks, Coda Audio Amplifier Comparator, Coda Audio System Controller, ViRAY, CUE-Series

Coda Audio's award winning sensor controlled technology is extended with the compact SCV-F subwoofer. Combining a closed feedback-loop control with large, low noise laminar flow ports the SCV-F subwoofer offers increased output and well controlled response. This technology goes ahead of conventional subwoofers offering measurable and clearly audible advantages in the impulse response, group delay, waterfall and the distortion domain. In fact the range 35 – 100 Hz is time aligned while the group delay increases slightly in the range 25 – 35 Hz. The reduced group delay results in extremely accurate and musical bass reproduction. The sound quality is far beyond conventional port loaded systems.

The 18" long excursion driver contains an integrated velocity sensor that measures the diaphragm movement in real

time, compares it with the input audio signal and adjusts the amplifier driving voltage and/or current, correcting any driver inaccuracy. It is a self-optimizing, closed feedback-loop in which the driver confirms precisely the power it needs to accurately reproduce the original audio signal. The key advantage is a very extended and controlled response. Any distortion produced by the driver or the enclosure is instantly corrected by the feedback.

Application

Primarily designed for integration into the ViRAY line arrays, the SCV-F is also suited for a variety of applications in touring and installations where compact size, high precision, deep bass with directivity control is needed.

TECHNICAL SPECIFICATIONS SCV-F

Type:	Sensor controlled subwoofer
Application:	Compact subwoofer
Frequency response:	25Hz (-6dB)
Power handling (AES / peak):	1500 W / 6000 W
Sensitivity 1 W / 1 m:*	97 dB
Maximum output peak:**	138 dB
Components:	2x 18" neodymium ultra low distortion woofers 4" (101.6 mm) voice coil, 15000 W (AES) each
Nominal impedance:	8 Ohm, +1 / -1
Cabinets per channel C10:	3 or 4***
Input connectors:	2x Neutrik™ NL4MP (rear) + 1x Neutrik™ NL4MP (front)
Velocity sensors output:	Neutrik™ NC3MAV (rear) + Neutrik™ NC3MAV (front)
Suspension:	Yes, allows curving (0°, 2.5°, 5°)
Enclosure material:	Baltic birch
Finish:	Polyurea coating (water resistant)
Dimensions (W x D x H):	674 x 490 x 790 mm
Net weight:	57 kg

* Half-space loading

** Measured with pink noise 6 dB crest factor

*** In cardio mode where channel A drives up to 4 SCV-F while channel B drives 2 SCV

ACCESSORIES SCV-F

FR-VR	Heavy duty frame for flying or ground stacking ViRAY and SCV-F
EXBAR-VR	Extension bar for FR-VR frame
TILT-VR	Tilting legs for ground stacking ViRAY/SCV-F on FR-VR
SH-VR	Shackle for FR-VR
DOL-SCV	Front dolly for single SCV-F
DOT-SCV	Transport dolly for up to 4 x SCV-F
CO SCV	Protection cover for single SCV-F
CO SCV-3	Protection cover for 3x SCV-F
CAH SCP-10	Hybrid speaker and sensor system cable 10m 1xNL4 Speakon® + 1x 5-PoiXLR-M 2xNL4 Speakon® + 2x 3-PoiXLR-F
CAH SCP-20	Hybrid speaker and sensor system cable 20m 1xNL4 Speakon® + 1x 5-PoiXLR-M 2xNL4 Speakon® + 2x 3-PoiXLR-F
CAL4SP-1.5	4-Pole loudspeaker cable, 4x4 mm ² 1,5m 1xNL4 Speakon®
CAL4SP-0.75	4-Pole loudspeaker cable, 4x4 mm ² 0.75m 1xNL4 Speakon®

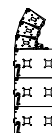
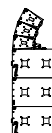
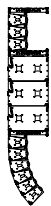
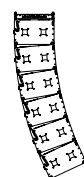
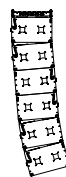

AIRLINE LA8



- Compact size, low weight
- Coda Audio Dual 4" Neodymium planar wave drivers (patent pending)
- Coda Audio Twin 8" neodymium ultra low distortion woofers
- All four drivers are physically time aligned
- Variable horizontal coverage of 120° or 60°
- Vertical Curving 0° to 12° variable in 1°-steps
- High efficiency
- Integrated rigging system for flown or ground stacked arrays
- System integration with AIRLINE LA8-SUB

- System components: Coda Audio System Racks, AIRLINE LA8-SUB, SCP, SC8

The LA8 is a compact, two-way full range line array module, designed for a wide range of applications where high fidelity sound and outstanding intelligibility is required. The cabinet contains two 8" neodymium ultra low distortion cone speakers and two 4" HF neodymium planar wave drivers.

The modules are designed to be used in multiples with a minimum configuration of three. Up to 20 units can be arrayed to achieve extreme high levels needed for larger venues. The built-in passive crossover allows multiple modules to be driven with a single amplifier channel (up to 6 enclosures at 3 Ohm). Bi-amplification is possible as well and is internally configurable. An optional AIRLINE LA8-SUB can be added for increased low frequency response.

The integrated rigging system allows quick and easy flying or ground stacking. Arrays may be built straight or curved in various angles to obtain the desired vertical coverage. The Coda EASE Focus simulation software allows you to calculate the perfect setup for every application.

When used together with AIRLINE LA8-SUB the AIRLINE LA8 line array gives audio companies a flexible plug and play system for a wide range of applications from the smallest venue up to full concert-system sound formats.

Applications include large clubs, convention centers, houses of worship, sport venues, stadiums, theatres, touring, open air, festivals and large scale corporate events

AIRLINE LA8

2-way full range line array module

TECHNICAL SPECIFICATIONS LA8

Type:	2-way full range line array module
Application:	Minimum 3, maximum 24 units line array
Frequency response:	70 Hz - 20 kHz (-3 dB)
Power handling (AES):	
Low:	500 W
High:	160 W
Sensitivity low:	99 dB
Max. SPL peak low:	132 dB
Sensitivity high:	115 dB
Max. SPL peak high:	146 dB
Dispersion Horizontal:	120° or 60°
Dispersion Vertical:	Array dependent, 0° - 12° in 1°-steps
Components:	
Low frequency:	2 x 8" neodymium woofer, carbon-fibre diaphragm 2" (51 mm) voice coil, 250 W (AES) each
High frequency:	2 x 4" neodymium planar wave drivers 1.75" (44.4 mm) voice coil, 80 W (AES) each
Crossover point:	1300 Hz passive or bi-amp (internal connector)
Input connectors:	2 x Neutrik™ NL4MP
Nominal impedance Passive:	16 Ohm (+2/-2)
2-way bi-amp operation:	LF: 16 Ohm (+1/-1) / HF: 16 Ohm (+2/-2)
Enclosure shape:	Horizontal trapezoid 2 x 6"
Enclosure material:	Baltic birch plywood
Finish:	Black textured paint
Flying hardware:	Included
Dimensions:	592 x 259 x 316 mm (incl. hardware)
Net weight:	17,7 kg

ACCESSORIES

FR8	Frame for AIRLINE LA8
FR128	Alteration frame kit for FR8, for flying AIRLINE LA8 under AIRLINE LA12
EXBAR 8	Extension bar for FR8 frame
CULA8	U-Bracket for AIRLINE LA8
FC8.4F	Flight Case for 4 x AIRLINE LA8 + 1 x FR8
FC8.4	Flight Case for 4 x AIRLINE LA8
Lift 45	Lift, 4.5 m high, for AIRLINE LA8

SYSTEM PERFORMANCE

Array	Horizontal Coverage	Vertical Coverage	Maximum Peak Output
1 Enclosure	120° or 60°	-	132 dB
2 Enclosures	120° or 60°	0 - 12° adjustable	138 dB
4 Enclosures	120° or 60°	0 - 48° adjustable	144 dB
8 Enclosures	120° or 60°	0 - 96° adjustable	150 dB

AIRLINE LA8-SUB

AIRLINE LA8-SUB

High output system subwoofer



- Coda Audio 18" neodymium ultra low distortion woofer
 - Low power compression, superb quality sound
 - Integrated rigging hardware for flown or ground stacked arrays
 - System integration with AIRLINE LA8 line arrays
- System components: Coda Audio System Racks, AIRLINE LA8, SCP

The AIRLINE LA8-SUB is an 18" system-subwoofer containing an extremely long excursion 18" neodymium ultra low distortion woofer in a ported cabinet. Equipped with the same rigging system as the AIRLINE LA8 it is ideal for easy

flying or ground stacking in various combinations providing compact plug and play line array system solution.

Primarily designed for integration into an AIRLINE LA8 line array, the AIRLINE LA8-SUB is also suited to general purpose subwoofer applications. It gives audio companies a flexible, plug and play complete solution for a wide range of applications from the smallest venue up to full concert-system sound format.

Applications include large clubs, convention centers, houses of worship, sport venues, stadiums, theatres, touring, open air, festivals and large scale corporate events.

TECHNICAL SPECIFICATIONS LA8-SUB

Type:	System subwoofer
Application:	AIRLINE LA8 array integration
Frequency response:	30 Hz to 120 Hz
Power handling (AES):	1200 W
Maximum output long term:	128 dB
Maximum output peak:	134 dB
Components:	18" neodymium ultra low distortion woofer 8 Ohm, 4" (101.6 mm) voice coil, 1200 W (AES)
Nominal impedance:	8 Ohm
Input connectors:	2 x Neutrik™ NL4MP
Suspension:	included
Enclosure material:	18 mm Baltic birch
Finish:	Textured black Paint
Dimensions:	592 x 503 x 700 mm
Net weight:	48 kg

ACCESSORIES

- FR8 Frame for AIRLINE LA8-SUB
- CO LA8-SUB-1 Protection cover for single AIRLINE LA8-SUB

RIGGING POSSIBILITIES LA8 + LA8-SUB

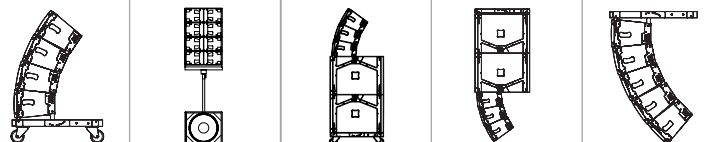

SCP / SCP-F



SCP

High output sensor controlled subwoofer

- 2 x 18" extreme high excursion woofers
- The integrated velocity sensor measures the voice coil movement
- Extended frequency range to 25 Hz (-6 dB)
- Omni or cardioid configurations
- Ultra low distortion
- Fast transient response, the upper and the ultra low frequency are time aligned
- Optional rigging hardware for flown or ground-stacked arrays (SCP-F)
- System components: Coda Audio System Racks, AIRLINE LA8, AIRLINE LA8-SUB, G700-Series, CUE-Series

The Coda Audio award winning sensor controlled technology is extended with the SCP-Series subwoofers. Combining a closed feedback-loop control with large, low noise laminar flow ports the SCP subwoofer offers increased output and well controlled response. This technology surpasses that of conventional subwoofers offering measurable and clearly audible advantages in the impulse response, group delay, waterfall and the distortion domain. In fact the range 35 – 100 Hz is time aligned while the group delay increases slightly in the range 25 – 35 Hz. The reduced group delay results in extremely accurate and musical bass reproduction. The sound quality is far beyond that of conventional port loaded systems.

The SCP is a sensor controlled subwoofer incorporating double 18" woofers in a compact, vented enclosure. The drivers contain an integrated velocity sensor that measures the diaphragm movement in real time, compares it with the input audio signal and adjusts the amplifier driving voltage and/or current, correcting any driver inaccuracy. It is a self-optimizing, closed feedback-loop in which the driver confirms precisely the power it needs to accurately reproduce the original audio signal. The key advantage is a



very extended and controlled response. Any distortion produced by the driver or the enclosure is instantly corrected by the feedback.

Application: The SCP is perfectly suited as a subwoofer for AIRLINE LA8, G700-Series and CUE-Series, extending the system performance down to 25Hz. Typical applications are touring sound, theaters, houses of worship, dance clubs and live sound venues.

TECHNICAL SPECIFICATIONS SCP / SCP-F

Type:	Sensor controlled subwoofer
Application:	High output subwoofer
Frequency response:	25 Hz (-3 dB) to 120 Hz
Power handling (AES / peak):	3000 W / 12000 W
Sensitivity 1 W / 1 m:*	103 dB
Maximum output peak:**	144 dB
Components:	2 x 18" neodymium ultra low distortion woofers, 4" (101.6 mm) voice coil, 1500 W (AES) each
Nominal impedance:	4 Ohm, +1 / -1
Input connectors:	2 x Neutrik™ NL4MP
Velocity sensors output:	1 x Neutrik™ NC3MAV
Suspension:	optional flying hardware: SCP-F
Enclosure material:	Baltic birch
Finish:	Black Polyurea coating (water resistant)
Dimensions:	1190 x 547 x 790 mm
Net weight:	95 kg

* Half-space loading

**Measured with pink noise 6 dB crest factor

ACCESSORIES

DOT SCP	Transport dolly for up to 3 units SCP
DOT SCP-F	Transport dolly for up to 3 units SCP-F
CAH SCP-10	Hybrid speaker and sensor cable for SCP subwoofers, 10 m
CAH SCP-20	Hybrid speaker and sensor cable for SCP subwoofers, 20 m
CO SCP-1	Protection cover for single SCP
CO SCP-2	Protection cover for 2 units SCP
CO SCPF-1	Protection cover for single SCP-F



SC4



SC4

Sensor controlled subwoofer

- 2 x Coda Audio 18" extreme high output subwoofer
- Velocity sensors for feedback loop control
- Extended frequency range down to 20 Hz (-6 dB), 25 Hz (-3 dB)
- Ultra low distortion
- Fast transient response, the upper and the ultra low frequency are time aligned
- Compact size for reduced labor and transport costs
- Optional rigging hardware

■ System components: Coda Audio System Racks, LA4, G700-Series, CUE-Series

The SC4 subwoofer

Sensor controlled subwoofer incorporating double 18" long excursion woofers in a sealed enclosure.

The SC4 subwoofer provides perfectly flat frequency response down to 20 Hz (-6 dB) and very high output and low distortion.

SC4 key technologies

- The advanced design aligns several new technologies for outstanding performance.
- Feedback loop control – ultra low distortion, very extended and controlled response
- Long excursion drivers with integrated velocity sensor

The Feedback loop controlled subwoofer has clear advantages over conventional amplifier / subwoofer solutions when it comes to sonic performance, output and size.

Application

The SC4 is suited for a variety of applications in touring and installations where high precision, deep bass is needed. It is perfectly suited for use in arenas, houses of worship, theatres and clubs.

TECHNICAL SPECIFICATIONS SC4

Type:	Sensor controlled subwoofer
Application:	High output subwoofer
Frequency response:	20 Hz (-6 dB) 25 Hz (-3 dB) to 150 Hz
Power handling (AES / peak):	3000 W / 12000 W
Sensitivity 1 W / 1 m:*	103 dB @ 50 Hz
Maximum output peak:**	144 dB
Components:	2 x 18" neodymium ultra low distortion woofers, 4" (101.6 mm) voice coil, 1500 W (AES) each
Nominal impedance:	4 Ohm, +1 / -1
Input connectors:	2 x Neutrik™ NL4MP
Velocity sensors output:	1 x Neutrik™ NC3MAV
Suspension:	Optional
Enclosure material:	Black Polyurea coating (water resistant)
Finish:	Textured black Paint
Dimensions:	760 x 545 x 780 mm
Net weight:	69 kg

*Half-space loading

**Measured with pink noise 6 dB crest factor

ACCESSORIES

DOT SC4	Transport dolly for 2 units SC4
CAH SC-10	Hybrid speaker and sensor system cable for SC subwoofers, 10 m
CAH SC-20	Hybrid speaker and sensor system cable for SC subwoofers, 20 m
CAY-6	Sensor cable adapter for SC4

RC-Series



RC-Series 19" touring racks

Coda Audio's AIRLINE/SC systems management solution provides power and DSP for all AIRLINE and Sensor controlled subwoofer applications. The RC-Series 19" amp racks comes in two touring versions and two installation versions.

Both the RC20T and the RC40T have been designed for touring applications. Offering two rack sizes that can be used independently or as multiples of each or in combination with each other. Flexibility and ease of use together with a practical eye on durability and safety have resulted in a complete matching management regime for the AIRLINE/SC-Series.

These racks can be ground stacked in the normal way or flown. The inter rack-to-rack connection system is also used for transport dolly connection, allowing for greater ease of placement and easy removal of dolly where required.

This smart, tough and practical solution is the only answer for use with all AIRLINE/Sensor controlled subwoofer systems and allows users total ease of use and constant control of system configuration.

These racks are optimized for touring applications providing easy to control plug and play solutions in a complete matching management regime for the AIRLINE/SC-Series.



RC20T



RC20T

19"/7U Touring Rack

Including:

- 1x 19"/7U Touring Rack
- 1x PD32 Power distribution 230V, 3 x 32A
- 1x CP22 Connector panel
- 1x Internal Cable set
- 2x C10 2-Channel amplifier with built in dual comparator
- 1x DNC260N Digital system controller
- 1x CO-RC20-1 soft cover for transport/weather protection
- Optional transport dolly DOT-RC

Application:

RC20T rack is optimized to power the following Coda Audio products:

- Large Touring: AIRLINE LA12
SC8
AIRLINE LA8 in bi-amp
- Small/Medium Touring: ViRAY
AIRLINE LA8 passive
AIRLINE LA8-SUB
SCP
SCV-F
- Stage monitoring: CUE ONE bi-amp

RC40T



RC40T

19"/11U Touring Rack

Including:

- 1x 19"/11U Touring Rack
- 1x PD32 Power distribution 230V, 3 x 32A
- 1x CP40 Connector panel
- 1x Internal Cable set
- 4x C10 2-Channel amplifier with built in dual comparator
- 1x DNC260N Digital system controller
- 1x CO-RC40-1 soft cover for transport/weather protection
- Optional transport dolly DOT-RC

Application:

RC40T rack is optimized to power the Coda Audio large touring products including:

- AIRLINE LA12
AIRLINE LA8 in bi-amp
ViRAY
SC8
SCV-F

TECHNICAL SPECIFICATIONS	RC20T	RC40T
Size:	19"/7U	19"/11U
Number of Amplifiers:	2	4
Shock Mounts:	Yes	Yes
Doors:	Sliding doors	Sliding doors
Castors:	opt. Dolly	opt. Dolly
Power distribution:	PD32, 3x32A	PD32, 3x32A
Connector panel:	CP22	CP40
Soft cover:	CO-RC20-1	CO-RC40-1
Weight:	66.8 kg	92.8 kg



LA5A



- Ultra compact self-powered line array system
- No need of external amplifier racks
- Two Coda Audio 4" neodymium planar wave driver (patent pending)
- Four Coda Audio 5" neodymium ultra low distortion woofers
- Wide horizontal coverage of 110°

LA5A

2-way self-powered full range line array system

- Vertical curving 0° to 10° in 1°-steps
- 500 W RMS class D amplifier for the low frequency plus a 180 W RMS MOSFET amplifier for the high frequency
- High SPL, superb sound quality
- Optical Limiters for state-of-the-art protection
- Integrated rigging system for flown or ground stacked arrays

■ System components: Coda Audio System Controller, LA5A-SUB, PW418Av²

The LA5A is an ultra compact, 2-way self-powered line array system, designed for a wide range of applications where high fidelity sound and outstanding intelligibility is required. The system contains four 5" neodymium ultra low distortion cone speakers and two 4" neodymium planar wave drivers. The use of high efficiency class D amplifier for the low frequency and MOSFET amp for the high frequency ensures small size, reduced weight and superb sonic performance. The integrated control electronic includes optical limiters for each channel, 24 dB phase-aligned asymmetrical crossovers, all pass filters and EQ to provide a perfect match between amplifiers and loudspeakers for optimum acoustic output and reliability. To be used in multiples with a minimum configuration of two. Up to 20 units can be used to achieve extreme high levels needed for larger venues. An optional LA5A-SUB self-powered subwoofer can be added for increased low frequency response. The integrated rigging system allows quick and easy flying or ground stacking. Arrays may be built straight or curved in various angels to obtain the desired vertical coverage. The fact that the LA5A is ultra compact and light reduces manpower and transport. When coupled with the LA5A-SUB the LA5A gives audio companies a flexible plug and play system for

a wide range of applications from the smallest venue up to full concert-system sound formats. Applications include arenas, convention centers, houses of worship, theatres, music pavilions and auditoriums.

TECHNICAL SPECIFICATIONS LA5A

Type:	2-way self-powered full range system
Application:	Minimum 2, maximum 20 units line array
Frequency response:	60 Hz - 19 kHz (-3 dB)
Maximum output long term:	124 dB
Maximum output peak:	130 dB
Dispersion:	110° x 10°
Amplifiers low range:	Class D
Power output (RMS):	500 W / 4 Ohm
THD + N:	<0.02% at 500 W, 1 kHz, 4 Ohm
Amplifier high range:	MOSFET 180 W, 500 W Burst
THD + N:	<0.02%
Components:	
Low frequency:	4x 5" neodymium woofers 1.5" (38 mm) voice coil, 125 W (AES) each
High frequency:	2x 4" neodymium planar wave drivers 1.75" (44.4 mm) voice coil, 80 W (AES) each
Crossover:	1.3 kHz 24 dB/O active
High pass filter:	44 Hz 18 dB/O
Input:	balanced
Connectors:	1x female XLR/TRS jack; 1x male XLR loop (pin2+; 3-, 1gnd)
Impedance:	10 kOhm
Input sensitivity:	0.775 V (RMS)
AC Connector:	2x Neutrik™ PowerCon (in/out)
AC Power requirement:	1000 W peak, 600 W continuous (max)
LED indicators:	Power on, signal, 0 dB, LF limit, HF limit, overload
Controls:	Gain -12 to 0 dB Top / full range mode, input phase
Enclosure shape:	Horizontal trapezoid 5°
Flying hardware:	Integrated
Enclosure material:	Birch plywood
Finish:	Textured black paint
Dimensions (WxHxD):	502x270x420 mm (incl. hardware)
Net weight:	24.5 kg

ACCESSORIES

FR5	Frame for LA5A	Cab5 main	System cable powercon + signal for LA5A /
CULA5A	U-Bracket LA5A		LA5A-SUB, 5 m
FC5	Flight Case for 4 x LA5A		
Cab5	System loop cable powercon + signal for LA5A	Pin5	Pin for LA5A
		Lift 45	Lift, 4.5 m high, for LA5A

SYSTEM PERFORMANCE

Array	Frequency response (-3 dB)	Vertical coverage (-6 dB)	Maximum Peak Output
1 Enclosure	60 – 20000 Hz	110° x 10°	130 dB
4 Enclosures	58 – 20000 Hz	110° x (10° - 40°)	142 dB
8 Enclosures	57 – 20000 Hz	110° x (10° - 80°)	148 dB

LA5A-SUB

LA5A-SUB

Self-powered subwoofer



- Compact self-powered high output subwoofer
- Coda Audio 15" neodymium ultra low distortion woofer
- 1000 W (RMS) Class D amplifier
- Low power compression, superb sound quality
- Optical limiter for state-of-the-art protection
- Integrated rigging hardware for flown or ground stacked arrays
- System integration with LA5A line arrays

■ System components: Coda Audio System Controller, LA5A, PW418Av²

The LA5A-SUB is a compact self-powered high output subwoofer incorporating a 1000 W high efficiency class D amplifier. The integrated control electronics include an optical limiter, 24 dB phase-aligned crossovers, subsonic filter and EQ to provide a perfect match between amplifier and loudspeaker for optimum acoustic output and reliability. The use of a high efficiency class D amplifier, together with the

newly developed neodymium loudspeakers, ensures small size, low weight and superb sonic performance.

Complimenting the LA5A full range line array system, the LA5A-SUB extends the system response down to 38 Hz. An excellent transient response produces fast high impact bass that is able to reproduce detailed and accurate low frequency information.

The LA5A-SUB is equipped with a 15" neodymium ultra low distortion woofer in a ported cabinet and provides the same rigging system as the LA5A for easy flying or ground stacking in various combinations. Primarily designed for system integration into LA5A line arrays, the LA5A-SUB is also suited as a general use subwoofer giving audio companies a flexible, plug and play system for a wide range of applications from the smallest venue up to full concert-system sound formats.

Applications include arenas, convention centers, houses of worship, theatres, music pavilions and auditoriums.

TECHNICAL SPECIFICATIONS LA5A-SUB

Type:	Self-powered subwoofer
Application:	LA5A sub extension
Frequency response:	38Hz to 125Hz or 160Hz (switchable)
Maximum output long term:	127dB
Maximum output peak:	133dB
Amplifier:	Class D
Power output (RMS):	1000W / 40hm
THD + N:	< 0.04% at 1000W, 100Hz, 40hm
Components:	15" neodymium ultra low distortion woofer 4Ω, 4" (101.6mm) voice coil, 1000W (AES)
Crossover:	30Hz 18dB/O high pass, 125/160Hz 24dB/O low pass
Input:	balanced
Connectors:	1x female XLR/TRS jack; 1x male XLR loop; 1x male XLR top 24dB/O high pass output @ 125/160Hz (pin2+ ;3-;1gnd)
Impedance:	10kΩ
Input sensitivity:	0.775V (RMS)
AC connector:	2x Neutrik™ PowerCon (in/out)
AC power requirements:	2000W peak, 1000W continuous (max)
LED indicators:	Power on, signal, 0dB, LF limit, overload
Controls:	Gain -12dB to 0dB x/o frequency 125Hz or 160Hz Input phase switch
Rigging hardware:	Integrated
Enclosure material:	18mm birch plywood
Finish:	Black textured paint
Dimensions (WxHxD):	502x455x600mm
Net weight:	38kg

ACCESSORIES

FR5	Frame for LA5A-SUB
Cab5-SUB	System loop cable powercon + signal for LA5A-SUB
Cab5 main	System cable powercon + signal for LA5A / LA5A-SUB, 5 m
Pin5	Pin for LA5A-SUB

RIGGING POSSIBILITIES LA5 + LA5-SUB

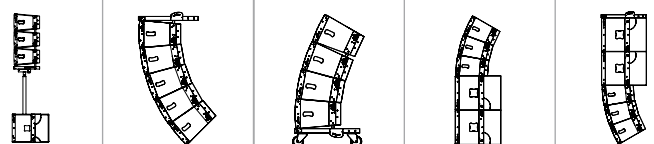

LA4



LA4

2-way full range line array module

- Ultra compact size, low weight
- Coda Audio 4" neodymium planar wave driver (patent pending)
- Two Coda Audio 5" neodymium ultra low distortion woofers
- Wide horizontal coverage of 110°
- Vertical curving 0° to 20° in 2°-steps
- High efficiency
- Full range capability
- Integrated rigging system for flown or ground stacked arrays
- System components: Coda Audio System Amplifier, Coda Audio System Controller, LA4-SUB, SC4, PW418v²

The LA4 is an ultra compact, 2-way full range line array system, designed for a wide range of applications where high fidelity sound and outstanding intelligibility are required. The system contains two 5" neodymium ultra low distortion cone speakers and a 4" neodymium planar wave driver. The system is designed to be used in multiples with a minimum configuration of four. Up to 40 units can be used to achieve the extreme high levels needed for larger venues. An optional LA4-SUB can be added for increased low frequency response.

The integrated rigging system allows quick and easy flying or ground stacking. Arrays may be built straight or curved in various angles to obtain the desired vertical coverage. The fact that the LA4 is ultra compact and light reduces manpower and transport. When coupled with LA4-SUB the LA4 gives audio companies a flexible plug and play system

for a wide range of applications from the smallest venue up to full concert-system sound formats.

Applications include large clubs, convention centers, houses of worship, sport venues, arenas, theatres, musicals, ballrooms, auditoriums, club touring and corporate events.

ACCESSORIES

- FR4 Frame for LA4
- CULA4 U-Bracket for LA4
- FC4 Flight Case for LA4
- Pin5 Pin for LA4
- Lift 45 Lift, 4.5 m high, for LA4

SYSTEM PERFORMANCE			
Array	Frequency response (-3 dB)	Vertical coverage (-6 dB)	Maximum Peak Output
1 Enclosure	60-20.000 Hz	110° x 10°	124dB
4 Enclosures	60-20.000 Hz	110° x 40°	136dB
8 Enclosures	58-20.000 Hz	110° x 60°	142dB

TECHNICAL SPECIFICATIONS LA4	
Type:	2-way full range system
Application:	Minimum 4, maximum 40 units line array
Frequency response:	60 Hz - 20 kHz (-3 dB)
Power handling AES:	250 W
Sensitivity low:	94 dB
Max. SPL peak low:	124 dB
Sensitivity high:	113 dB
Max. SPL peak high:	139 dB
Dispersion:	110° x 10°
Components:	
Low frequency:	2x 5" neodymium woofers, 1.5" (38 mm) voice coil, 125 W (AES) each
High frequency:	1x 4" neodymium planar wave driver, 1.75" (44.4 mm) voice coil, 80 W (AES)
Crossover point:	1300 Hz passive
Nominal impedance:	16 Ω
Input connectors:	2x Neutrik™ NL4MP
Enclosure shape:	10° horizontal trapezoid
Enclosure material:	Birch plywood
Finish:	Black textured paint
Flying hardware:	Integrated
Dimensions (WxHxD):	500x178x320 mm (incl. hardware)
Net weight:	9.65 kg

LA4-SUB

LA4-SUB

System subwoofer



- Coda Audio 15" neodymium ultra low distortion woofer
- Low power compression, superb quality sound
- Integrated rigging hardware for flown or ground stacked arrays
- System integration with LA4 line arrays

- System components: Coda Audio System Amplifier, Coda Audio System Controller, LA4, SC4, PW418v²

The LA4-SUB is a 15" system subwoofer containing an extremely long excursion 15" neodymium ultra low distortion woofer in a ported cabinet. Equipped with the same rigging system as the LA4 it is ideal for easy flying and ground stacking in various combinations providing compact plug & play line array system solutions.

Specially designed for integration into LA4 line arrays, the LA4-SUB is also suited to general purpose subwoofer applications. It gives audio companies a flexible, plug and play complete solution for a wide range of applications from the smallest venue to a concert-level sound.

Applications include large clubs, convention centers, houses of worship, sport venues, arenas, theatres, musicals, ballrooms, auditoriums, club touring and corporate events.

TECHNICAL SPECIFICATIONS LA4-SUB

Type:	System subwoofer
Application:	LA4 array integration
Frequency response:	40 Hz to 160 Hz
Power handling (AES):	1000 W
Maximum output long term:	127 dB
Maximum output peak:	133 dB
Components:	15" neodymium ultra low distortion woofer, 8 Ohm, 4" (101.6 mm) voice coil, 1200 W (AES)
Nominal Impedance:	8 Ohm
Input connectors:	2x Neutrik™ NL4MP
Suspension:	included
Enclosure material:	18 mm Baltic birch
Finish:	Textured black paint
Dimensions (WxHxD):	502x455x600 mm
Net weight:	32 kg

ACCESSORIES

FR4	Frame for LA4-SUB
Pin5	Pin for LA4-SUB

RIGGING POSSIBILITIES LA4 + LA4-SUB

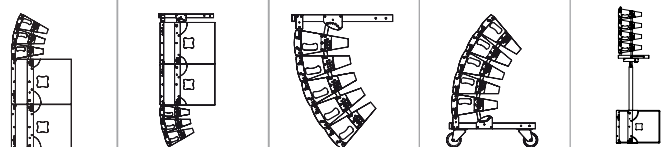

Coda EASE Focus II Software

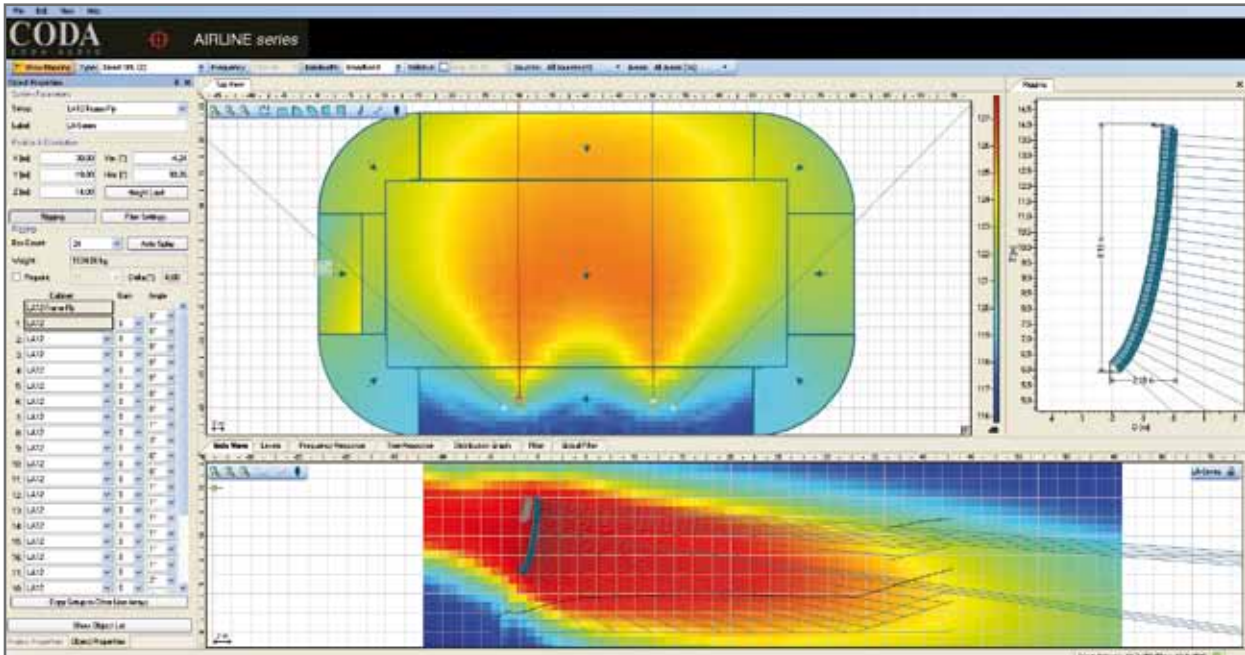

Coda EASE Focus II Software

- 3D modeling of direct sound, displayed in horizontal and vertical cutting planes
- Full support for EASE GLL files and data exchange with EASE
- Capability to use multiple line array systems in a single project
- Virtual equalizer for tuning a line array in the simulation
- Support for digitally steered columns and other configurable loudspeakers; this requires an additional proprietary DLL that can provide e.g. beam steering filters
- Full frequency range from 20 Hz to 20 kHz
- High accuracy due to high internal data resolution and GLL data format
- Support for multiple languages: German, English, Spanish, Italian, Portuguese

Coda Audio EASE Focus II is a three-dimensional, acoustic simulation software for the configuration and modeling of line array systems and of adjustable loudspeakers, such as digitally steered columns. EASE Focus II is free for the end user.

In EASE Focus II, each line array or column loudspeaker is described by a so-called system definition which contains the mechanical, electronic and acoustic properties of the loudspeaker system. All available GLL-files for Coda Audio speakers can be downloaded from our website.

Great efforts have been made to keep EASE Focus II intuitive and easy-to-use while introducing three-dimensional coordinates and many new features. It can be considered a tool for both the end user, who needs to set up the sound system for a show, as well as for the R&D engineer, who is interested in the acoustic qualities of the array design. EASE Focus II is the optimal tool for easy and quick prediction of the sound system performance in a given venue. Compared to conventional aiming software the applicability of EASE Focus II is much larger. It is not fixed to a single loudspeaker product.

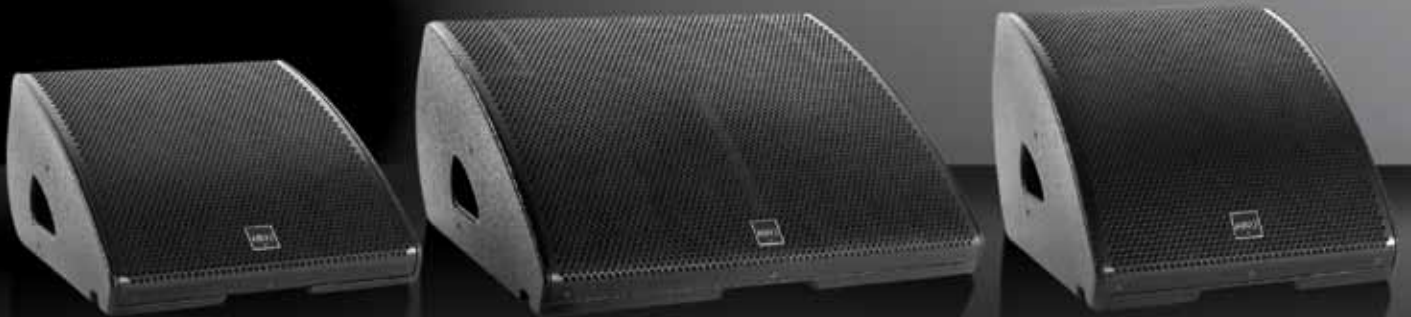

3-way high output ultra low profile stage monitor series

The CUE Series is a family of dedicated stage monitors, each with its own group of application areas. The design strategy allows Coda Audio to deliver a, “no compromise” approach to fulfilling a large number of real world Monitoring requirements. In addition the sonic signature of the series means they can all be used together as and when required.

The CUE-Series 3-way high output ultra low profile stage monitors feature a triaxial design, engineered without compromise to provide a true one point source.

The advanced design aligns the acoustical centers of the transducers to produce a single point source. This unique loudspeaker technology provides a coherent wave front without hot spots. Precise directivity ensures uniform coverage with perfect time alignment between the components.



CUE ONE



CUE ONE

3-way high output ultra low profile stage monitor

- 3-way coherent point source technology
 - Double 12" and 1.4" coax driver
 - Asymmetrical vertical coverage 55° + 40°
 - Outstanding audio quality
 - Ultra low feedback
 - Ultra low profile design
 - Integrated hardware for increased dispersion
 - Powerful low frequency response
 - Mechanically durable
 - Discrete cables connection
 - Passive or bi-amp operation
 - Light weight
- System components: Coda Audio System Racks or Coda Audio System Amplifier, SC4

The cabinet contains double 12" extremely high power neodymium woofers and a 1.4" coaxial compression driver loaded by an asymmetrical 60° x 55°+40° elliptical wave-guide.

The CUE ONE has the power handling and power output to suite the largest of monitoring applications, while still being discreet and low profile in physical form. Unique cabling format and integrated hardware for adjusting dispersion along with a rotatable HF wave guide provide users total flexibility of use. The CUE ONE's design and the technologies used, truly allow monitor engineers to be creative with their on stage audio designs, bring that same level of Audio attention to be found at the FOH to the stage.

TECHNICAL SPECIFICATIONS CUE ONE	
Type:	3-way high output stage monitor
Application:	Stage monitor
Frequency response:	54 Hz - 21 kHz (-3 dB)
Power handling AES:	2000 W
Peak Power:	8000 W
Sensitivity:*	104 dB
Max. SPL peak:	143 dB
Dispersion:	
Horizontal:	60°
Vertical:	55° + 40°
Components:	
Low frequency:	2 x 12" neodymium woofer, 4" (101.6 mm) voice coil, 1000 W
High frequency:	1.4" neodymium coaxial driver 3.5" (90 mm), + 1.75" (44.4 mm) voice coil, 150 W + 80 W
Crossover:	750 Hz passive or bi-amp (internal connector), 6.3 kHz passive
Nominal impedance:	4 Ohm
Input connectors:	2x Neutrik™ NL4MP
Enclosure material:	15 / 18 mm plywood
Finish:	Textured black paint
Dimensions:	670 x 322 x 627 mm
Net weight:	32 kg

ACCESSORIES

- A1HC Horizontal U-bracket for CUE ONE
- A1WM Wall mount bracket for CUE ONE
- FC1CUE Flight case for 2x CUE ONE
- CFA Flying Adapter for CUE-Series
- CSF Stand fitting for CUE-Series
- CO SC8x2 Protection cover for 2x SC8 / SC8F

* Half-space loading

CUE TWO

CUE TWO

3-way high output ultra low profile stage monitor



- 3-way coherent point source technology
- 15" / 1.4" triaxial transducer
- 60° x 90° elliptical waveguide
- Outstanding audio quality
- Ultra low feedback
- Integrated hardware for increased dispersion

- Powerful low frequency response
- Mechanically durable
- Discrete cables connection
- Passive or bi-amp operation
- Light weight

- System components: Coda Audio System Racks or Coda Audio System Amplifier, SC4

TECHNICAL SPECIFICATIONS CUE TWO

Type:	3-way high output stage monitor
Application:	Stage monitor
Frequency response:	54 Hz - 21 kHz (-3 dB)
Power handling AES:	1000 W
Peak Power:	4000 W
Sensitivity:*	103 dB
Max. SPL peak:	139 dB
Dispersion:	
Horizontal:	60°
Vertical:	90°
Components:	
Low frequency:	15" neodymium woofer 4" (101.6 mm) voice coil, 1000 W
High frequency:	1.4" neodymium coaxial driver 3.5" (90 mm) + 1.75" (44.4 mm) voice coil, 150 W + 80 W
Crossover:	750 Hz passive or bi-amp (internal connector), 6.3 kHz passive
Nominal impedance:	8 Ohm
Input connectors:	2x Neutrik TM NL4MP
Enclosure material:	15 / 18 mm plywood
Finish:	Textured black paint
Dimensions:	540 x 379 x 574 mm
Net weight:	29 kg
Weatherproof version:	Optional

* Half-space loading

The cabinet contains a triaxial transducer incorporating an extremely high power 15" neodymium cone driver and a 1.4" coaxial compression driver concentrically mounted to the woofer and loaded by a 60° x 90° elliptical waveguide.

The CUE TWO has the same unique physical characteristics to be found across the series when it comes to cable connection and variable dispersion hardware, while being based on a true triaxial transducer design with a symmetrical HF 60 x 90 wave guide. The resulting total coherence of the unit delivers both power and a purity of sonic reproduction that is world class.

ACCESSORIES

A2HC	Horizontal U-bracket for CUE TWO
A2WM	Wall mount bracket for CUE TWO
FC2CUE	Flight case for 2x CUE TWO
CFA	Flying Adapter for CUE-Series
CSF	Stand fitting for CUE-Series



CUE FOUR



CUE FOUR

3-way high output ultra low profile stage monitor

- 3-way coherent point source technology
 - Double 8" and 1.4" coax driver
 - Asymmetrical vertical coverage 55°+ 40°
 - Outstanding audio quality
 - Ultra low feedback
 - Ultra low profile design
 - Integrated hardware for increased dispersion
 - Mechanically durable
 - Discrete cable connection
 - Passive or bi-amp operation
 - Light weight
- System components: Coda Audio System Racks or Coda Audio System Amplifier, SC4

The cabinet contains double 8" high power neodymium woofers and a 1.4" coaxial compression driver loaded by an asymmetrical 60° x 55°+40° elliptical waveguide.

The CUE FOUR may be the smallest in the family, but don't let that fool you; once again the CUE FOUR has all the inherent technologies to be found in the series in a smaller footprint. This reduction in physical size and weight makes the CUE FOUR particularly useful in applications where restrictions in placement play their part. This is a big, little monitor, delivers the same high quality audio reproduction and coherency as the CUE ONE and the CUE TWO with the added advantage of being small, low profile and light weight. The CUE FOUR has wall mounting accessories to assist placement in specific applications such; TV studios, Houses of Worship and orchestras.

ACCESSORIES

A4HC	Horizontal U-bracket for CUE FOUR
A4WM	Wall mount bracket for CUE FOUR
FC4CUE	Flight case for 4x CUE FOUR
CFA	Flying Adapter for CUE-Series
CSF	Stand fitting for CUE-Series

TECHNICAL SPECIFICATIONS CUE FOUR

Type:	3-way high output stage monitor
Application:	Stage monitor
Frequency response:	54 Hz - 21 kHz (-3 dB)
Power handling AES:	500 W
Peak Power:	2000 W
Sensitivity:*	104 dB
Max. SPL peak:	137 dB
Dispersion:	
Horizontal:	60°
Vertical:	55° + 40°
Components:	
Low frequency:	2 x 8" neodymium woofers, 2" (52 mm) voice coil, 250 W (AES) each
High frequency:	1.4" neodymium coaxial driver 3.5" (90 mm) + 1.75" (44.4 mm) voice coil, 150 W + 80 W
Crossover:	750 Hz passive or bi-amp (internal connector), 6.3 kHz passive
Nominal impedance:	8 Ohm
Input connectors:	2x Neutrik™ NL4MP
Enclosure material:	15 / 18 mm plywood
Finish:	Textured black paint
Dimensions:	545 x 450 x 272 mm
Net weight:	19 kg
Weatherproof version:	Optional

* Half-space loading



The G-Series range, compact versatile full range systems that incorporate the best driver and waveguide technology available today.

Rotatable waveguides

The newly designed elliptical waveguides offer exceptional directivity control without internal diffraction and resonances. Going beyond the classical horn theory the new design significantly reduces horn resonances and audibly improves the sound quality.

Audiophile grade neodymium HF drivers

All compression drivers utilise patented annular diaphragm design and contain CuCup technology to reduce intermodulation distortion IMD. The neodymium cone drivers include triple aluminum demodulating rings for ultra low distortion and increased power handling.

Ultra low distortion neodymium cone drivers

The long excursion cone drivers contain high flux, linear motors with triple demodulation rings for ultra low distortion and increased power handling.

System integration

Although the G-Series loudspeakers incorporate dedicated passive crossovers ensuring linear frequency and phase response allowing them to work without additional processing, the use of Coda Audio's digital controllers dramatically improves the overall system performance offering protection and frequency response optimization either in full range mode or in stage monitor applications or in combination with subwoofers.

Accessories and Hardware

Optimized for installation and touring the G-Series features M6 flying points for optional u-brackets to mount them to walls or ceilings as well as special hardware kits for almost every kind of installation or touring application.

Other Features:

- Best sound quality
- Maximum output and reliability in their class
- Competitive price





G300-Series – 2-way compact full-range systems

- Extreme compact multidesign enclosure
- Wide coverage angles
- 1" patented compression driver
- Multiple fly-points for easy hanging
- Extended accessories range for both touring and installation

Superior sound quality designed for near field applications containing the finest drivers and a wide dispersion symmetrical wood waveguides for uncoloured high fidelity sound. The systems provide a smart solution for installations, bands, small clubs, 5.1 surround and corporate events or as a stage monitor.

G500-Series – medium output 2-way full-range systems

- Superb quality patented annular diaphragm
- 1" neodymium HF drivers
- Ultra low distortion woofers with 3" VC and triple demodulation rings
- Rotatable elliptical waveguides
- M6 suspension points
- Versatile enclosures
- Extended accessories range for both touring and installation

These 2-way systems are rated at 600 W continuous power and are best suited for sound reinforcement applications where the best sound quality at moderate levels is required. The G500-Series incorporates 12" and 15" neodymium drivers with 3" voice coil and a 1" annular diaphragm compression driver mounted on an elliptical waveguide. Offering the very best performance / cost ratio the G500-Series is suited for installations, bands, stage monitoring, DJs and clubs.

G700-Series – High output 3-way full-range systems

- 3-way systems where the mid and high frequency are radiated from one point
- Unique patented 1.4" coaxial neodymium driver
- Ultra low distortion woofers with 4" VC and triple demodulation rings
- Internal selector for passive or bi-amp operation
- Rotatable elliptical waveguides
- M6 suspension points
- Versatile enclosures
- Extended accessories range for both touring and installation

The G700-Series incorporates 12" and 15" neodymium drivers with 4" voice coil and 1.4" neodymium coaxial compression drivers mounted on elliptical waveguides. Rated at 1000 W continuous power handling the 700-Series is suited for touring and installation applications where the highest output and outstanding sound quality are required. At the heart of the G700-Series is the patented 1.4" neodymium coaxial compression driver. An extremely wide and flat frequency response is achieved at high sensitivity due to the unique construction. The advanced design aligns the acoustical centers of the mid and high frequency range to produce a single point source. This unique loudspeaker technology provides a coherent wave front without hot spots. Precise directivity ensures uniform coverage with perfect time alignment between the components.

G308 / G308F**G308 / G308F**

Compact 2-way full range system



- Extreme compact multidesign enclosure
- Wide coverage angles
- 1" patented compression driver
- Multiple fly-points for easy hanging
- Extended accessories range for both touring and installation
- G308F features integrated flange adapter
- System components: Coda Audio System Amplifier, Coda Audio System Controller, G15-SUB, G18-SUB

TECHNICAL SPECIFICATIONS G308

Type:	2-way full range system, multidesign enclosure
Application:	High quality short throw
Frequency response:	70 Hz - 30 kHz (-3 dB)
Power handling AES:	220 W
Program power:	440 W
Peak power:	880 W
Sensitivity:	94.5 dB
Max. SPL peak:	124 dB
Dispersion:	90° conical
Components:	
Low frequency:	8" ultra low distortion cone driver, 2" voice coil
High frequency:	1" compression driver, 1.5" voice coil
Crossover point:	1900 Hz
Nominal impedance:	8 Ohm
Input connectors:	2x Neutrik™ NL4MP
Enclosure material:	Birch plywood
Suspension:	2x M6 threaded points
Flange adapter:	G308F only
Dimensions (WxHxD):	230 x 471 x 260 mm
Net weight:	9.5 kg
	Human EQ-switch

The Coda Audio G308 is a compact versatile full range 2-way loudspeaker system that features an 8" ultra low distortion low frequency driver and a 1" compression driver coupled to a 90° conical wood waveguide.

The G308 incorporates a multidesign enclosure fitted with M6 flying points enabling it to be used horizontal, vertical or as a floor monitor.

ACCESSORIES

FC308	Flight case for 2x G308 / G308F
A8VG	Vertical U-bracket for G308 / G308F
A8HG	Horizontal U-bracket for G308 / G308F
GFA	Flying Adapter for G308
GSF	Stand fitting for G308
M6	Ring for rigging G308 / G308F
A68620	Truss Clamp for G308 / G308F

G512-96



G512-96

2-way compact full range multidesign

- 2-way compact versatile full range system
- High power handling of 600 W
- Neodymium drivers for light weight
- 90° x 60° rotatable elliptical waveguide
- Designed for both PA and stage monitoring
- System components: Coda Audio System Amplifier, Coda Audio System Controller, G15-SUB, G18-SUB

The G512-96 is a versatile full range two-way loudspeaker system that features ultra low distortion 12" neodymium woofer and a 1" neodymium compression driver coupled to a 90° x 60° rotatable elliptical waveguide. The G512 incorporates a multi design enclosure fitted with M6 threaded points for use with an optional U-bracket and includes an integral top hat. Applications include clubs, corporate events, FOH, stage monitor and band PA.

TECHNICAL SPECIFICATIONS G512-96

Type:	2-way full range system, multidesign enclosure
Application:	High quality short throw or stage monitor
Frequency response:	60 Hz – 21 kHz (-3 dB)
Power handling AES:	600 W
Peak power:	2400 W
Sensitivity:	98 dB
Max. SPL peak:	132 dB
Dispersion:	90°x 60°
Components:	
Low frequency:	12" neodymium woofer, 3" (77 mm) voice coil, 600 W (AES)
High frequency:	1" neodymium compression driver, 1.75" (44.4 mm) VC, 80 W (AES)
Crossover point:	1300 Hz passive
Nominal impedance:	8 Ω
Input connectors:	2 x Neutrik™ NL4MP
Suspension:	M6 threaded points for use of optional U-bracket
Enclosure material:	15/18 mm birch plywood
Finish:	Textured black paint
Dimensions (WxHxD):	348 x 630 x 320 mm
Net weight:	16 kg
Weatherproof version:	Optional

ACCESSORIES

A12VG	Vertical U-bracket for G512-96
A12HG	Horizontal U-bracket for G512-96
24481	Wall Mount for G512-96
GFA	Flying Adapter for G512-96
M6 Ring	for rigging G512-96
AK2G	Array kit for 2 x G512-96

G515-96**G515-96**

2-way high power full range multidesign



- 2-way compact versatile full range system
- High power handling of 600 W
- Neodymium drivers for light weight
- 90° x 60° rotatable elliptical waveguide
- Designed for both PA and stage monitoring
- System components: Coda Audio System Amplifier, Coda Audio System Controller, G15-SUB, G18-SUB

TECHNICAL SPECIFICATIONS G515-96

Type:	2-way full range system, multidesign enclosure
Application:	High quality short throw or stage monitor
Frequency response:	50 Hz - 21 kHz (-3dB)
Power handling AES:	600 W
Peak power:	2400 W
Sensitivity:	98 dB
Max. SPL peak:	132 dB
Dispersion:	90°x 60°
Components:	
Low frequency:	15" neodymium woofer, 3" (77 mm) voice coil, 600W (AES)
High frequency:	1" neodymium compression driver, 1.75" (44.4 mm) voice coil, 80W (AES)
Crossover point:	1200 Hz passive
Nominal impedance:	8 Ω
Input connectors:	2 x Neutrik™ NL4MP
Suspension:	M6 threaded points for use of optional U-bracket
Enclosure material:	15 mm birch plywood
Finish:	Textured black paint
Dimensions (WxHxD):	420 x 700 x 370 mm
Net weight:	17.5 kg
Weatherproof version:	Optional

The G515-96 is a versatile full range two-way loudspeaker system that features ultra low distortion 15" neodymium woofer and a 1" neodymium compression driver coupled to a 90° x 60° rotatable elliptical waveguide. The G515 incorporates a multidesign enclosure fitted with M6 threaded points for use with an optional U-bracket and includes an integral top hat. Applications include clubs, corporate events, FOH, stage monitor and band PA.

ACCESSORIES

A15VG	Vertical U-bracket for G515-96
A15HG	Horizontal U-bracket for G515-96
24481	Wall Mount for G515-96
GFA	Flying Adapter for G515-96
M6 Ring	for rigging G515-96
AK2G	Array kit for 2 x G515-96

G712-96**G712-96**

3-way compact full range multidesign

- 3-way high output versatile full range system
 - Unique 1.4" coaxial neodymium driver
 - 90° x 60° rotatable elliptical waveguide
 - 12" neodymium ultra low distortion woofer
 - Passive or bi-amplified operation
 - Designed for fixed installation, touring and stage monitoring
- System components: Coda Audio System Racks or Coda Audio System Amplifier, G18-SUB, SCP, SC4

The Coda Audio G712-96 is a versatile full range 3-way loudspeaker system that features a high power 12" neodymium woofer and a 1.4" coaxial neodymium driver coupled to a rotatable 90° x 60° elliptical waveguide. As a 3-way system the G712-96 may be driven passively or with bi-amplification to provide extremely high acoustic output. The Coda Audio G712-96 is a powerful solution for front of house touring, installed PA for theatres, clubs and corporate events or as a stage monitor.

TECHNICAL SPECIFICATIONS G712-96

Type:	3-way high power full range system, multidesign enclosure
Application:	High output short/medium throw or stage monitor
Frequency response:	60 Hz – 21 kHz (-3 dB)
Power handling AES:	1000 W
Peak power:	4000 W
Sensitivity:	98 dB
Max. SPL peak:	134 dB
Dispersion:	90° x 60°
Components:	
Low frequency:	12" neodymium woofer, 4" (101.6 mm) voice coil, 1000 W (AES)
High frequency:	1.4" neodymium coaxial driver, 3.5" (90 mm) + 1.75" (44.4 mm) voice coil, 150 W + 80 W (AES)
Crossover point:	750 Hz, 6.3 kHz passive
Nominal impedance:	8 Ω
Input connectors:	2 x Neutrik™ NL4MP
Suspension:	6 x M6 threaded points
Enclosure material:	15 / 18 mm Baltic birch plywood
Finish:	Textured black paint (all RAL-colours optional)
Dimensions (WxHxD):	348 x 630 x 320 mm
Net weight:	21.5 kg
Weatherproof version:	Optional

ACCESSORIES

A12VG	Vertical U-bracket for G712-96
A12HG	Horizontal U-bracket for G712-96
24481	Wall Mount for G712-96
GFA	Flying Adapter for G712-96
M6 Ring	for rigging G712-96
AK2G	Array kit for 2 x G712-96

G715-96**G715-96**

3-way compact full range multidesign



- 3-way high output versatile full range system
 - Unique 1.4" coaxial neodymium driver
 - 90° x 60° rotatable elliptical waveguide
 - 15" neodymium ultra low distortion woofer
 - Passive or bi-amplified operation
 - Designed for fixed installation, touring and stage monitoring
- System components: Coda Audio System Racks or Coda Audio System Amplifier, G18-SUB, SCP, SC4

TECHNICAL SPECIFICATIONS G715-96

Type:	3-way high power full range system, multi design enclosure
Application:	High output short/medium throw or stage monitor
Frequency response:	50 Hz - 21 kHz (-3 dB)
Power handling AES:	1000 W
Peak power:	4000 W
Sensitivity:	98 dB
Max. SPL peak:	134 dB
Dispersion:	90°x60°
Components:	
Low frequency:	15" neodymium woofer, 4" (101.6 mm) voice coil, 1000 W (AES)
High frequency:	1.4" neodymium coaxial driver, 3.5" (90 mm) + 1.75" (44.4 mm) voice coil, 150 W + 80 W (AES)
Crossover point:	750 Hz, 6.3 kHz passive
Nominal impedance:	8 Ω
Input connectors:	2 x Neutrik™ NL4MP
Suspension:	6 x M6 threaded points
Enclosure material:	15 / 18 mm Baltic birch plywood
Finish:	Textured black paint (all RAL-colours optional)
Dimensions (WxHxD):	420 x 700 x 370 mm
Net weight:	24.5 kg
Weatherproof version:	Optional

The Coda Audio G715-96 is a versatile full range 3-way loudspeaker system that features a high power 15" neodymium woofer and a 1.4" coaxial neodymium driver coupled to a rotatable 90° x 60° elliptical waveguide. As a 3-way system the G715-96 may be driven passively or with bi-amplification to provide extremely high acoustic output. The Audio G715-96 is a powerful solution for front of house touring, installed PA for theatres, clubs and corporate events or as a stage monitor.

ACCESSORIES

A15VG	Vertical U-bracket for G715-96
A15HG	Horizontal U-bracket for G715-96
24481	Wall Mount for G715-96
GFA	Flying Adapter for G715-96
M6 Ring	for rigging G715-96
AK2G	Array kit for 2 x G715-96



G-SUB-Series



- Coda Audio ultra low distortion neodymium woofer
- System integration with G-Series full range systems
- Low power compression

The G-SUBs are professional port loaded subwoofers designed to complement the G-Series full range systems for portable, touring and install applications. Equipped with the newest generation neodymium high excursion drivers they provide high output extended low frequency response with punch and definition.

State-of-the-art drivers

The G-SUBs are equipped with an extremely long excursion neodymium ultra low distortion woofer. The neodymium motor delivers extreme high magnetic flux for increased efficiency. The 4" voice coil is 38 mm high, ensuring ultra linear excursion of 26 mm / pp at consistent magnetic force.



G15-SUB

G15-SUB

Compact high output subwoofer



- Coda Audio 15" ultra low distortion neodymium woofer
 - Extended frequency response down to 38 Hz
 - System integration with the G500-Series 2-way full range systems
 - Maximum SPL 138 dB (peak)
 - Low power compression
- System components: Coda Audio System Amplifier, Coda Audio System Controller, G308, G512-96, G515-96

The G15-SUB is a 15" compact subwoofer that provides powerful low frequency response. Low port compression and optimized enclosure design give a tight, accurate bass response that is ideally suited as a sub-extension for the G500-Series systems.

State-of-the-art drivers

The G15-SUB is equipped with an extremely long excursion 15" neodymium ultra low distortion woofer. The neodymium motor delivers extreme high magnetic flux for increased efficiency. The 4" voice coil is 38 mm high, ensuring ultra linear excursion of 26 mm / pp at consistent magnetic force. State-of-the-art carbon-fiber cone ensures maximum stiffness and low moving mass.

Three aluminum shorting rings reduce intermodulation distortion, minimize induction variation while reducing thermal compression. This design dramatically reduces the distortion of a typical subwoofer at longer excursion levels, and improves the overall sound quality and performance characteristics of the cabinet.

Applications

The G15-SUB is perfectly suited as a sub-extension for the G500-Series systems and can be used in Houses of Worship, Theatres, clubs and mobile applications.

TECHNICAL SPECIFICATIONS G15-SUB

Type:	15" subwoofer
Application:	Compact high output subwoofer
Frequency response (-6 dB):	38 Hz - 180 Hz
Power handling (AES/peak):	1250 W / 5000 W
Sensitivity 1 W / 1 m:*	101 dB
Maximum output peak:**	138 dB
Components:	15" neodymium ultra low distortion woofer, 4" (101.6 mm) voice coil, 1250 W (AES)
Nominal impedance:	8 Ohm, +1 / -1
Input connectors:	2x Neutrik™ NL4MP
Suspension:	Optional
Enclosure material:	Baltic birch
Finish:	Textured black paint
Dimensions:	520 x 431 x 630 mm
Net weight:	34 kg

* Half-space loading

** Measured with pink noise 6 dB crest factor

ACCESSORIES

DOT-G15-SUB	Transport dolly for G15-SUB
CO G15-1	Protection cover for 1x G15-SUB



G18-SUB



G18-SUB

Extended low frequency subwoofer

- Coda Audio 18" ultra low distortion neodymium woofer
- Extended frequency response down to 28 Hz
- System integration with G700-Series systems
- Maximum SPL 139 dB (peak)
- Low power compression

- System components: Coda Audio System Amplifier, Coda Audio System Controller, G512-96, G515-96, G712-96, G715-96

The G18-SUB is an 18" compact subwoofer that provides powerful and extended low frequency response. Low port compression and optimized enclosure design give a tight, accurate bass response that is ideally suited as a sub-extension for the G700-Series systems.

State-of-the-art drivers

The G18-SUB is equipped with an extremely long excursion 18" neodymium ultra low distortion woofer. The neodymium motor delivers extreme high magnetic flux for increased efficiency. The 4" voice coil is 38 mm high, ensuring ultra linear excursion of 26 mm / pp at consistent magnetic force.

State-of-the-art carbon-fiber cone ensures maximum stiffness and low moving mass. Three aluminum shorting rings reduce intermodulation distortion, minimize induction variation while reducing thermal compression. This design dramatically reduces the distortion of a typical subwoofer at longer excursion levels, and improves the overall sound quality and performance characteristics of the cabinet.

Applications:

The G18-SUB is perfectly suited as a sub-extension for the G700-Series systems and can be used in Houses of Worship, Theatres, clubs and mobile applications.

TECHNICAL SPECIFICATIONS G18-SUB

Type:	18" subwoofer
Application:	Extended low frequency subwoofer
Frequency response (-6 dB):	28 Hz - 120 Hz
Power handling (AES/peak):	1250 W / 5000 W
Sensitivity 1 W / 1 m:*	102 dB
Maximum output peak:**	139 dB
Components:	18" neodymium ultra low distortion woofer, 4" (101.6 mm) voice coil, 1250 W (AES)
Nominal impedance:	8 Ohm, +1 / -1
Input connectors:	2x Neutrik™ NL4MP
Suspension:	Optional
Enclosure material:	Baltic birch
Finish:	Textured black paint
Dimensions:	630 x 505 x 780 mm
Net weight:	46 kg

* Half-space loading

** Measured with pink noise 6 dB crest factor

ACCESSORIES

- DOT-G18-SUB Transport dolly for G18-SUB
- CO G18-1 Protection cover for 1x G18-SUB



2-way line source column system

Applying true Coda Audio line array technology, which is available in our large touring products, into an ultra compact size, passive column loudspeaker, filling the gap between larger, more expensive line arrays and point source systems, offering high quality solutions for acoustically difficult environments.

CoRAY4 is an extremely advanced 2-way line source solution for all highly reverberant environments. CoRAY4 has been designed to provide exacting results in situation where the natural environment is particularly unforgiving to normal amplified sound reinforcement solutions.



CoRAY4

CoRAY4



CoRAY4

2-way line source column system

- 2-way ultra compact line source column system
 - High power handling of 700 W
 - Dual 4" neodymium planar wave drivers
 - Four 5" ultra low distortion cone speakers
 - Asymmetrical vertical coverage of 12° (1° up, 11° down)
 - Variable horizontal dispersion of 120° or 60° or asymmetrical 90°
 - Integrated CMS (Coda Mobile Suspension), optimized for mobile use
- System components: Coda Audio System Amplifier, Coda Audio System Controller, G15-SUB, G18-SUB, SC4, CoRAY4L

Description:

The CoRAY4 is an ultra compact two-way line array column, designed for small to mid-sized venues with difficult acoustic environments where compact size, high fidelity sound and outstanding intelligibility are required.

The cabinet contains four 5" ultra low distortion cone speakers and two 4" HF neodymium planar wave drivers.

Versatility:

The possibility to change the horizontal coverage 120°, 60° or asymmetrical 90° (60°+30°) or (30°+60°) allows precise audience coverage, reduced reflections for better intelligibility. The asymmetrical vertical coverage focuses the sound to the listeners considerably reducing reflections from the ceiling.

Two CoRAY4s can be allied top on top as CoRAY4 Twin, to create consistent symmetrical vertical coverage of 24° without interferences between the cabinets while the horizontal coverage can be modified from 120° to 60° or 120° for short throw and 60° for long throw sending more energy in the far field. In this configuration the system acoustical output will increase by 6 dB and narrow vertical control at

low frequency for extending the long throw capabilities of the system.

System Solutions:

IMPORTANT: The CoRAY4 is NOT designed to work without dedicated system controller and therefore should be used only with proper Coda Audio controllers. The controller will equalize the system and will ensure limiter protection. Digital signal processing is available in Coda Audio System Amplifiers and standalone Coda Audio Digital Controllers. The C5 is an integrated solution for DSP control and amplification of CoRAY4. It provides 4 inputs and 4 amplifier outputs as well as network remote control and diagnostic. Presets for CoRAY4 are available. An optional G15-SUB or G18-SUB can be added for increased low frequency response.

Options:

Standard RAL colours and weather protection options are available on request.

Applications include worship, live music, political events, conferences, corporate events, delay line for AIRLINE LA8 or LA4 line arrays.



CoRAY4 L



CoRAY4L

Low frequency extension for CoRAY4



- Ultra compact low frequency extension for CoRAY4
- High Power handling of 700W

- Four 5" ultra low distortion cone speakers
- Integrated CMS (Coda Mobile Suspension) optimized for mobile use

The CoRAY4L is an ultra compact low frequency extension for the CoRAY4. The cabinet contains four 5" ultra low distortion cone speakers and features the same CMS (Coda Mobile Suspension) as the CoRAY4 for an integrated fixing solution.

TECHNICAL SPECIFICATIONS CoRAY4

Type:	2-way passive column loudspeaker
Frequency response:	80 Hz - 20 kHz (-3 dB)
Power handling AES:	700 W
Peak power:	2800 W
Sensitivity:	97 dB
Max. SPL peak:	131 dB
Dispersion horizontal:	Symmetrical 120° or 60° or asymmetrical 90° (60° + 30°)
Vertical:	12° (1° up, 11° down)
Components:	
Low frequency:	4x 5" Woofer, 1.5" (38mm) voice coil, 170 W (AES)
High frequency:	2x 4" Neodymium planar wave drivers, 1.75" (44.4 mm) voice coil, 80 W (AES)
Crossover point:	1300 Hz passive
Nominal impedance:	4 Ω
Input connectors:	2x Neutrik™ NL4MP
Suspension:	CMS (Coda Mobile Suspension)
	M6 threaded points for use of optional U-bracket
Enclosure material:	Birch plywood
Finish:	Black Polyurea coating (water resistant)
Dimensions (W x H x D):	152 x 758 x 214 mm
Net weight:	15.7 kg
Weatherproof/colour version:	Optional

* Subject to technical alteration without prior notice

ACCESSORIES

CF4	Flying frame
CA4	Twin adaptor for 2x CoRAY4
C4VC	U-bracket
C4WM	Wall mount bracket
TV4	TV spigot for CF4 flying frame
TV4C	Clamp for TV spigot
19674	Speaker tilt connector 0°-15°
24481	Wall mount for CoRAY4 Twin
COB-CoRAY4	Transportation bag for single CoRAY4

TECHNICAL SPECIFICATIONS CoRAY4L

Type:	Low frequency extension for CoRAY4
Frequency response:	80 Hz - 1300 Hz (-3 dB)
Power handling AES:	700 W
Peak power:	2800 W
Sensitivity:	97 dB
Max. SPL peak:	131 dB
Components:	4x 5" woofer, 1.5" (38 mm) voice coil, 170 W (AES)
Nominal impedance:	4 Ω
Input connectors:	2x Neutrik™ NL4MP
Suspension:	CMS (Coda Mobile Suspension)
	M6 threaded points for use of optional U-bracket
Enclosure material:	Birch plywood
Finish:	Black Polyurea coating (water resistant)
Dimensions (W x H x D):	152 x 758 x 214 mm
Net weight:	13.2 kg
Weatherproof version:	Optional



CoRAY4i

CoRAY4i



CoRAY4i

2-way line source column system

- 2-way ultra compact line source column system
- High power handling of 700 W
- Dual 4" neodymium planar wave drivers
- Four 5" ultra low distortion cone speakers
- Asymmetrical vertical coverage of 12° (1° up, 11° down)
- Variable horizontal dispersion of 120° or 60° or asymmetrical 90°
- Optimized for permanent installations

- Coda Audio System Amplifier and/or Controller, G15-SUB, G18-SUB, SC4, CoRAY4Li

Description:

The CoRAY4i is an ultra compact two-way line array column, designed for small to mid-sized venues with difficult acoustic environments where compact size, high fidelity sound and outstanding intelligibility is required. The cabinet contains four 5" ultra low distortion cone speakers and two 4" HF neodymium planar wave drivers.

Versatility:

It is possible to change the horizontal coverage between 120°, 60° or asymmetrical 90° (60°+30°) or (30°+60°) which allows precise audience coverage, reduced reflections resulting in better intelligibility.

Two CoRAY4i's can be aligned, top to top as CoRAY4 Twin, to create a consistent symmetrical vertical coverage of 24° without interferences between the cabinets while the horizontal coverage can be modified from 120° to 60° or 120° for short throw and 60° for long throw sending more energy to the far field.

In this configuration the system's acoustical output will increase by 6 dB and narrow vertical control at low frequency for extending the long throw capabilities of the system.

System solutions:

IMPORTANT: The CoRAY4i is NOT designed to work without dedicated system controller and therefore should be used only with proper Coda Audio controllers. The controller will equalize the system and will ensure limiter protection. Digital signal processing is available in Coda Audio System Amplifiers and standalone Coda Audio Digital Controllers. Presets for CoRAY4 are available.

The C5 is an integrated solution for DSP control and amplification of CoRAY4i. It provides 4 inputs and 4 amplifier outputs as well as network remote control and diagnostic. The optional addition of a Coda Audio G15-SUB or G18-SUB can be used when increased low frequency response is required.

Options:

Standard RAL colours and weather protection options are available on request.

Applications include Houses of worship, small theatres, convention centres, conference rooms, political events, airports, museums, shopping malls, corporate events, delay line for AIRLINE LA8 or LA4 line arrays.

CoRAY4iL



CoRAY4iL

Low frequency extension for CoRAY4i



- Ultra compact low frequency extension for CoRAY4i
- High Power handling of 700W
- Four 5" ultra low distortion cone speakers
- Optimized for permanent installations

The CoRAY4iL is an ultra compact low frequency extension for the CoRAY4i. The cabinet contains four 5" ultra low distortion cone speakers and features M6 threaded points on all surfaces, optimized for permanent installations.

TECHNICAL SPECIFICATIONS CoRAY4i

Type:	2-way passive column loudspeaker
Frequency response:	80 Hz - 20 kHz (-3 dB)
Power handling AES:	700 W
Peak power:	2800 W
Sensitivity:	97 dB
Max. SPL peak:	131 dB
Dispersion horizontal:	Symmetrical 120° or 60° or asymmetrical 90° (60° + 30°)
Vertical:	12° (1° up, 11° down)
Components:	
Low frequency:	4x 5" Woofer, 1.5" (38mm) voice coil, 170 W (AES)
High frequency:	2x 4" Neodymium planar wave drivers, 1.75" (44.4 mm) voice coil, 80 W (AES)
Crossover point:	1300 Hz passive
Nominal impedance:	4 Ω
Input connectors:	2x Neutrik™ NL4MP
Suspension:	M6 threaded points
Enclosure material:	Birch plywood
Finish:	Textured black paint
Dimensions (W x H x D):	152 x 755 x 214 mm
Net weight:	15.7 kg
Weatherproof/colour version:	Optional

*Subject to technical alteration without prior notice

ACCESSORIES

CF4i	Flying frame
CA4i	Twin adaptor for 2x CoRAY4i
C4VC	U-bracket
C4WM	Wall mount Bracket
24481	Wall mount for CoRAY4i Twin

TECHNICAL SPECIFICATIONS CoRAY4Li

Type:	Low frequency extension for CoRAY4i
Frequency response:	80 Hz - 1300 Hz (-3 dB)
Power handling AES:	700 W
Peak power:	2800 W
Sensitivity:	97 dB
Max. SPL peak:	131 dB
Components:	4x 5" woofer, 1.5" (38 mm) voice coil, 170 W (AES)
Nominal impedance:	4 Ω
Input connectors:	2x Neutrik™ NL4MP
Suspension:	M6 threaded points for use of optional U-bracket
Enclosure material:	Birch plywood
Finish:	Textured black paint
Dimensions (W x H x D):	152 x 758 x 214 mm
Net weight:	12.7 kg
Weatherproof version:	Optional



D-Series installation speakers



The D-Series range, precise, accurate and compact, a no compromise approach to near-fill sound reinforcement applications where highest quality audio is achieved via true point source technology.

This unique loudspeaker technology aligns the acoustical centres of the transducers providing a coherent wave front without hot-spots.

The latest generation of Coda's advanced coaxial technology is found across the growing range; their high output and ultra low distortion characteristics combined with precise directivity to ensure uniform coverage with perfect time alignment between the components, the D-Series is recognised for its high quality powerful sonic quality.

The D-Series, incorporating D5-Tube / D5-Ceiling / D5-Cube and D8 is further enhanced by the introduction of

the new D12 2-way passive system and the new D20, a true full-range 3-way system. Both the D12 and the D20 embrace all the benefits of Coda's point source technology while each have additional key design advantages which deliver an even wider set of solutions; high power before feedback, symmetrical coverage, extended low frequency response, true full-range performance, compact form and a full mounting accessories suite, just some of the exacting highlights that grace these advanced system.

D-Series - a state of the art solution for just about any installed sound reinforcement application.

D5-Tube / D5-Ceiling



D5-Tube

D5-Ceiling



- Ultra compact 2-way coaxial system
 - Coda Audio 5"/1" coaxial loudspeaker
 - Attractive solid aluminum design
 - Single point source system providing coherent wave front
 - Superb quality sound
 - Impedance 16 Ohm for easy daisy chaining
- System components: Coda Audio System Amplifier, Coda Audio System Controller, PW112, PW12A

TECHNICAL SPECIFICATIONS D5-Tube

Type:	2-way coaxial ultra compact
Application:	Superior quality short throw
Frequency response:	90 Hz - 30 kHz (-3dB)
Power handling AES:	125 W
Program power:	250 W
Peak power:	500 W
Sensitivity:	91 dB
Max. SPL peak:	117 dB
Dispersion:	90° conical
Components:	
Low frequency:	5" woofer, 1.5" (38 mm) voice coil, 120 W (AES)
High frequency:	1" coaxially mounted driver, 1.75" (44.4 mm) voice coil, 80 W (AES)
Crossover point:	1600 Hz passive
Nominal impedance:	16 Ω
100V version (optional):	100 VA
Input connectors:	2x Neutrik™ NL4MP
Enclosure material:	Solid aluminum
Finish:	Metal (all RAL-colours optional available)
Weatherproof version:	Optional
Flying hardware:	M8 Thread
Dimensions (Ø x D) D5-Tube:	170 x 193 mm
Dimensions (Ø x D) D5-Ceiling :	170 x 193 mm, ceiling cut out Ø160 mm
Net weight:	4 kg

The Coda D5-Tube is a passive 2-way 5" / 1" coaxial loudspeaker system designed without compromise to provide a true one point source in an ultra compact package.

The D5-Tube incorporates an attractive cylindrical solid aluminum enclosure supplied with a U-bracket. The cabinet contains a high power 5" woofer and a coaxially mounted driver with 44.4 mm voice coil. The advanced design aligns the acoustical centers of the transducers to produce a single point source. This unique loudspeaker technology provides a coherent wave front without hot spots. Precise directivity of 90° conical ensures uniform coverage with perfect time alignment between the components.

Supported with a full range of mounting and flying accessories the D5-Tube sets a state of the art solution for almost any high quality, near field installed sound reinforcement applications, such as conference, restaurants, pubs, shopping centres, clubs, convention centres, houses of worship, airports and 5.1 surround.

Also available D5-Tube 100 V including 100 V trafo, 100 VA and D5-Ceiling for ceiling suspended installation.

ACCESSORIES

CUV200	Vertical U-bracket for D5-Tube (included in delivery)
A68620	Truss Clamp for D5-Tube



D5-Cube



D5-Cube

2- way passive installation system

- Ultra compact 2-way coaxial system
- Coda Audio 5"/1" coaxial loudspeaker
- Attractive solid aluminium design
- Single point source system providing coherent wave front
- Superb quality sound
- Impedance 16 Ohm for easy daisy chaining
- System components: Coda Audio System Amplifier, Coda Audio System Controller, PW112, PW12A

The Coda D5-Cube is a passive 2-way 5" / 1" coaxial loudspeaker system designed without compromise to provide a true one point source in an ultra compact package. The cabinet contains a high power 5" woofer and a coaxially mounted driver with 44.4 mm voice coil. The advanced design aligns the acoustical centres of the transducers to produce a single point source. This unique loudspeaker technology provides a coherent wave front without hot spots. Precise directivity of 90° conical ensures uniform coverage with perfect time alignment between the components.

Supported with a full range of mounting and flying accessories the D5-Cube sets a state of the art solution for almost any high quality, near field installed sound reinforcement applications, such as conferences, restaurants,

pubs, shopping centres, clubs, convention centres, houses of worship, airports and 5.1 surround. Also available D5-Cube 100 V including 100 V trafo, 100 VA.

TECHNICAL SPECIFICATIONS D5-Cube

Type	2-way coaxial ultra compact
Application:	Superior quality short throw
Frequency response:	90 Hz - 30 kHz (-3 dB)
Power handling AES:	125 W
Program power:	250 W
Peak Power:	500 W
Sensitivity:	91 dB
Max. SPL peak:	117 dB
Dispersion:	90° conical
Components:	
Low frequency:	5" woofer, 1.5" (38 mm) voice coil, 120 W (AES)
High frequency:	1" coaxially mounted driver, 1.75" (44.4 mm) voice coil, 80 W (AES)
Crossover point:	1600 Hz passive
Nominal impedance:	16 Ω
100 V version (optional):	100 VA
Input connectors:	Push buttons
Enclosure material:	12/15 mm birch multiplex
Weatherproof version:	Optional
Suspension:	M6 threaded points, 3/8 thread for stand
Dimensions (WxHxD):	160x160x160 mm
Net weight:	3.5 kg

ACCESSORIES

CU5DC	Vertical U-bracket for D5-Cube (included in delivery)
24185	Wall Mount for D5-Cube
24471	Wall Mount for D5-Cube
A68620	Truss Clamp for D5-Cube

D8

D8

2-way passive installation system



- Ultra compact 2-way coaxial system
- Coda Audio 8"/1" coaxial loudspeaker
- Single point source system providing coherent wave front
- Superb quality sound
- M6 flying points
- Improved transient response

- System components: Coda Audio System Amplifier, und Coda Audio System Controller, PW115, PW118

The Coda D8 is a 2-way coaxial loudspeaker system designed without compromise to provide a true one point source in an ultra compact package. The cabinet contains

a high power 8" woofer and a coaxially mounted driver with 44.4 mm voice coil. The advanced design aligns the acoustical centres of the transducers to produce a single point source. This unique loudspeaker technology provides a coherent wave front without hot spots. Precise directivity of 90° conical ensures uniform coverage with perfect time alignment between the components.

Also available D8 100 V including 100 V trafo, 100 VA.

Supported with a full range of mounting and flying accessories the D8 delivers a state-of-the-art solution for almost any high quality, near field installed sound reinforcement applications such as conference, theatres, clubs, convention centers, airports and 5.1 surround.

TECHNICAL SPECIFICATIONS D8

Type:	2-way coaxial ultra compact
Application:	Superior quality short throw
Frequency response:	70 Hz - 20 kHz (-3 dB)
Power handling AES:	250 W
Program power:	500 W
Peak power:	1000 W
Sensitivity:	95 dB
Max. SPL peak:	124 dB
Dispersion:	90° conical
Components:	
Low frequency:	8" neodymium woofer, 2" (52 mm) voice coil, 250 W (AES)
High frequency:	1" neodymium driver, 1.75" (44.4 mm) voice coil, 80 W (AES)
Crossover point:	1500 Hz passive
Nominal impedance:	16 Ω
100 V version (optional):	100 VA
Input connectors:	2x Neutrik™ NL4MP
Enclosure material:	12/15mm birch multiplex
Finish:	Textured black paint (all RAL-colors optional)
Weatherproof version:	Optional
Flying Hardware:	M6 threaded points
Dimensions (WxHxD):	230x348x263 mm
Net weight:	7 kg

ACCESSORIES

CU8DV	Vertical U-bracket for D8
CU8DH	Horizontal U-bracket D8
24185	Wall Mount for D8
24171	Wall Mount for D8
195/8	Stand fitting for D8
M6 Ring	for rigging D8

D12



D12

2- way passive installation system

- Compact 2-way coherent point source technology
 - 12" ultra low distortion driver with 3" VC and triple demodulation rings
 - Coaxially mounted 1.75" annular diaphragm superb quality HF driver
 - High power handling of 600 W (AES)
 - Symmetrical coverage of 90°
 - Superior sound quality
 - Optimized for near-field applications
 - High output before feedback
 - System integration with LINUS amplifiers
 - Integrated M6 flying points
- System components: Coda Audio System Amplifier, Coda Audio System Controller, System Subwoofer

The Coda D12 is a passive 2-way coaxial loudspeaker system designed without compromise to provide a true one point source in a compact package. The cabinet contains a high power 12" woofer and a coaxially mounted ring diaphragm high frequency driver with 44.4mm voice coil.

The advanced design aligns the acoustical centers of the transducers to produce a single point source. This unique loudspeaker technology provides a coherent wave front without hot spots. Precise directivity of 90° conical ensures uniform coverage with perfect time alignment between the components. Supported with a full range of mounting and flying accessories the D12 sets a state of the art solution for almost any high quality, near field installed sound reinforcement applications.

ADVANCED DRIVER TECHNOLOGY

At the heart of the D12 is the new developed 12"/1,75" coaxial driver. The 12" cone driver covers the 60 - 1.300 Hz range with high efficiency and smooth, linear response. Three aluminium shorting rings reduce inter-modulation distortion; minimize induction variation while reducing thermal compression. The coaxially mounted high frequency driver contains an ultra light 1,75" annular diaphragm providing exceptional transient response with very high efficiency from 1kHz to 20 kHz. This new transducer was engineered to radiate a single source, coherent 90° wave front for superior dispersion control and high fidelity sound.

SYSTEM SOLUTION

The D12 is designed to work exclusively with dedicated Coda Audio LINUS or C3/C5 amplifiers as an integrated solution for DSP control, amplification, network remote control and diagnostic. The integrated solution ensures optimal performance and protection.

OPTIONS

Additional colours and weather protection options are available on request.

APPLICATIONS

Supported with a full range of mounting and flying accessories the D12 sets a state of the art solution for almost any high quality, near field installed sound reinforcement applications.

TECHNICAL SPECIFICATIONS D12

Type:	Compact 2-way coaxial installation system
Application:	Superior quality near field applications
Frequency response:	60 Hz - 20 kHz (-4 dB)
Power handling AES:	600 W
Peak power:	2400 W
Sensitivity:	98 dB*
Max. SPL peak:	132 dB**
Dispersion:	90° conical
Components:	
Low frequency:	12" woofer, 3" (77mm) VC, 600 W (AES)
Mid/High frequency:	Annular diaphragm compression driver, 1.75" (44.4 mm) VC, 80 W (AES)
Crossover:	1.2 kHz passive
Nominal impedance:	4 Ω
Cabinets per amp channel:	1***
Input connectors:	2x Neutrik™ NL4MP
Suspension:	10 x M6 threaded points
Enclosure material:	Birch plywood
Finish:	Black Polyurea coating (water resistant)
Dimensions (WxHxD):	342 x 452 x 425 mm
Net weight:	19kg
Weatherproof version:	Optional

* Half-space loading

** Measured with pink noise 6 dB crest factor

*** In low SPL applications up to 2 x D12 per channel can be connected

ACCESSORIES

CUD12V	Vertical U-bracket for D12	24481	Wall mount
CUD12H	Horizontal U-bracket for D12	DSF	Stand fitting
DFA	Flying adapter	M6	Ring

- 3-way coherent point source technology
- True full range performance (35 Hz – 20 kHz)
- 8"/1.75" coaxial driver and 12" extremely high excursion cone driver
- High power handling of 1000 W (AES)
- Symmetrical coverage of 90°
- Optimized for near-field applications

D20

True full range
3-way point source

D20

- System components: Coda Audio System Amplifier, Coda Audio System Controller

HISTORY

Large studio monitors are engineered to produce extended low frequencies at low levels. Whereas, full range PA loudspeakers are not really full range; they are optimized for high efficiency above 60Hz so require additional subwoofers to extend the lower frequency range. There are few if any professional solutions for a compact cabinet providing extended low frequency at high SPL. D20 is such a solution - a compact 3-way point source designed without compromise to provide extended low frequency at high level.

DESCRIPTION

The D20 is a passive 3-way full range compact system, designed for installation applications where extended low frequencies and superior dispersion control are required.

TECHNICAL SPECIFICATIONS D20

Type:	Compact 3-way true full range installation system
Application:	Superior quality near-field applications with extended low range
Frequency response:	35 Hz - 20 kHz (-4 dB)
Power handling AES:	1000 W
Peak power:	4000 W
Sensitivity:	97 dB*
Max. SPL peak:	133 dB**
Dispersion:	90° conical
Components:	
Low frequency:	12" woofer, 1000 W (AES)
Mid/High frequency:	8"/1.75" coaxial driver, Mid: 2" (51 mm), High: 1.75" (44.4 mm) voice coil, 180 W + 80 W (AES)
Crossover:	300 Hz, 1.3 kHz passive
Nominal impedance:	4 Ω
Cabinets per amp channel:	1***
Input connectors:	2x Neutrik™ NL4MP
Suspension:	10x M6 threaded points
Enclosure material:	Birch plywood
Finish:	Polyurea black coating (water resistant)
Dimensions (WxHxD):	342 x 700 x 425mm
Net weight:	26 kg
Weatherproof version:	Optional

* Half-space loading

** Measured with pink noise 6 dB crest factor

*** In low SPL applications up to 2 x D20 per channel can be connected

TRUE FULL RANGE

The 12" ultra low distortion cone driver covering the range 35 Hz – 400 Hz. with 3" voice coil, ensuring linear excursion, and 3 aluminum shorting rings reduce inter-modulation distortion; minimize induction variation while reducing thermal compression. This design reduces dramatically the distortion of a typical subwoofer at longer excursion levels, and improves the overall sound quality providing deep and punchy bass.

TRUE COCHERENT

At the heart of the D20 is the newly developed 8"/1.75" coaxial driver. The 8" cone midrange covers the 200 - 1.800 Hz range. The high frequency driver contains an ultra light 1.75" annular diaphragm providing exceptional transient response with very high efficiency from 1kHz to 20 kHz.

CONTROLLED DISPERSION AT HIGH SPL

The low and mid range are overlapped in the range 200 – 400 Hz while mid and high range are overlapped in the 1 – 1.8 kHz range. This increases the maximal SPL of the system providing improved directivity control.

SYSTEM SOLUTION

The D20 is designed to work exclusively with dedicated Coda Audio LINUS or C3/C5 amplifiers as an integrated solution for DSP control, amplification, network remote control and diagnostic. The integrated solution ensures optimal performance and protection.

OPTIONS

Additional colours and weather protection options are available on request.

APPLICATIONS

Designed for small to medium installation applications where extended low frequency range at high level is required without the use of additional subwoofers.

ACCESSORIES

CUD20V	Vertical U-bracket for D20	24481	Wall mount
CUD20H	Horizontal U-bracket for D20	DSF	Stand fitting
DFA	Flying adapter	M6	Ring

K-Series



K-Series 2-way compact full range systems provide superior sound quality designed for small to medium sized sound reinforcement applications.

Containing the finest 1" annular ring diaphragm drivers mounted to elliptical waveguides and ultra low distortion woofers the systems provide powerful solutions for installations, bands, clubs and corporate events or as a stage monitor.

Optimized for installation and portable usage the K-Series features M6 suspension points for optional U-brackets and other accessories.

Although the K-Series loudspeakers incorporate dedicated passive crossovers ensuring linear frequency and phase response allowing them to work without additional processing, the use of the DNC260 digital controller improves dramatically the overall system performance offering protection and frequency response optimization either in full range, stage monitor applications or in combination with subwoofers.

K4

K5

K4



2-way compact full range system

- Ultra compact 2-way versatile full range system
- Coda Audio 5" ultra low distortion woofer
- Elliptical waveguide for precise directivity and less distortion
- Superb sound quality
- M6 Flying points
- Improved transient response

K5



2-way compact full range system

- Ultra compact 2-way full range system
- Coda Audio Double 5" ultra low distortion woofer
- Elliptical waveguide for precise directivity and less distortion
- Superb sound quality
- M6 flying points
- Improved transient response

■ System components K4 / K5: Coda Audio System Amplifier, Coda Audio System Controller, PW112

The Coda Audio K4 is an ultra compact versatile, full range, 2-way loudspeaker system that features a 5" ultra low distortion low frequency driver; the 1" compression driver is coupled to a rotatable 90° x 60° elliptical waveguide. The K4 incorporates a multi design enclosure enabling it to be used horizontally, vertically or as a floor monitor. The addition of flying hardware as standard together with the ability to rotate the elliptical waveguide allows multipurpose applications including conferences, corporate events, PA-systems and houses of worship.

The Coda Audio K5 is an ultra compact full range 2-way loudspeaker system that features double 5" ultra low distortion cone drivers and a 1" compression driver coupled to a rotatable 90° x 60° elliptical waveguide. The addition of M6 flying points as a standard together with the ability to rotate the elliptical waveguide allows multipurpose applications including conferences, corporate events, PA-systems and houses of worship.

ACCESSORIES

CU4V Vertical U-Bracket for K4 A68620 Truss Clamp for K4
195/8 Stand fitting for K4

ACCESSORIES

CU52V Vertical U-Bracket for K5 A68620 Truss Clamp for K5
195/8 Stand fitting for K5

TECHNICAL SPECIFICATIONS K4	
Type:	2-way full range multi design
Application:	Superior quality short throw
Frequency response:	80 Hz – 30 kHz (-3 dB)
Power handling AES:	125 W
Program power:	250 W
Peak power:	500 W
Sensitivity:	92 dB
Max. SPL peak:	118 dB
Dispersion:	90° x 60°
Components:	
Low frequency:	5" / 1.5" voice coil ultra low distortion woofer
High frequency:	1" / 1.5" voice coil compression driver
Crossover point:	1600 Hz passive
Nominal impedance:	16 Ohm
Input connectors:	2 x Neutrik™ NL4MP
Enclosure material:	12 mm Baltic birch
Finish:	Textured black paint
Flying Hardware:	8 x M6 threaded points
Dimensions:	160 x 330 x 184 mm
Net weight:	5.45 kg

TECHNICAL SPECIFICATIONS K5	
Type:	2-way full range
Application:	Superior quality short throw
Frequency response:	80 Hz – 30 kHz (-3 dB)
Power handling AES:	250 W
Program power:	500 W
Peak power:	1000 W
Sensitivity:	94 dB
Max. SPL peak:	124 dB
Dispersion:	90° x 60°
Components:	
Low frequency:	2 x 5" / 1.5" voice coil ultra low distortion woofers
High frequency:	1" / 1.5" voice coil compression driver
Crossover point:	1600 Hz passive
Nominal impedance:	16 Ohm
Input connectors:	2 x Neutrik™ NL4MP
Enclosure material:	12 / 15 mm Baltic birch
Finish:	Textured black paint
Flying hardware:	6 x M6 threaded points
Dimensions:	160 x 480 x 184 mm
Net weight:	7 kg



PW12A



PW12A

Self-powered subwoofer with satellite amps

- Active tri-amp subwoofer with amplifier outlets for stereo tops
- Coda Audio 12" neodymium ultra low distortion woofer
- 1000 W plus 2 x 500 W class D amplifiers
- Low power compression, superb sound quality

PW12



PW12

Passive subwoofer

- Optical Limiters for state-of-the-art protection
- Optimized to power the Coda G-, K- and D-Series passive cabinets
- Capable to drive an additional passive subwoofer PW12

- System components PW12A: G308, D5-Tube, K289i, D5-Cube, PW12

PW12A is an active tri-amp system subwoofer with amplifier outlets for passive tops containing 2000 W amplification and processing for a complete stereo sub / satellite system.

The electronics: integrates one 1000 W for the low frequency and 2 x 500 W high efficiency class D amplifiers for the top cabinets. The advanced analogue processor includes optical limiters for each channel, 24 dB phase-aligned cross-overs, subsonic filters and EQ to provide a perfect match between amplifiers and loudspeakers for optimum acoustic output and reliability. The use of high efficiency class D amplifier for the subwoofer and for the tops ensures small size, reduced weight and superb sonic performance.

The loudspeaker: 12" high power, long excursion neodymium ultra low distortion woofer providing powerful and extended low frequency response down to 30 Hz.

System integration: Optimized to work together with the G-, K- and D-Series full range passive cabinets, the PW12A can be connected to diverse mid-high loudspeakers for different applications to build a complete stereo sub / satellite system. An integrated speaker output enables an additional passive subwoofer (PW12) to be used increasing

the system low frequency output by 6 dB without the need for additional processing and amplifier racks. Applications: Used in a wide variety of configurations they provide compact and economical plug and play solution for bands, small PA-systems, mobile DJ 's or permanent installations.

TECHNICAL SPECIFICATIONS PW12	
Power handling RMS:	600 W
Program power:	1200 W
Peak power:	4800 W
Sensitivity:	96 dB, 1 W / 1 m
Nominal impedance:	8 Ohm
Input connectors:	2 x Neutrik™ NL4MP
Dimensions:	398 x 454 x 465 mm
Net weight:	21 kg
Same as the PW12A without the amplifier.	

TECHNICAL SPECIFICATIONS PW12A	
Type:	Self-powered subwoofer cabinet with satellite amps
Application:	Small / medium venues subwoofer
Frequency response:	30 Hz to 110 Hz
Maximum SPL peak:	127 dB single cabinet, 133 dB (PW12A + PW12 as slave)
Amplifier Sub:	Class D
Max. power output (RMS):	1000 W / 4 Ohm
Peak output current:	50 A
THD + N:	0.04% @ 1000 W, 100 Hz, 4 Ohm
Amplifiers Top:	2x 500 W Class D, 4 Ohm continuous, 2x 600 W burst
Components:	12" neodymium high excursion woofer 8 Ohm, 3" (77 mm) voice coil, 600 W (AES)
Crossover:	20 Hz high pass 18 dB, 100 Hz low pass 24 dB, EQ
Input:	Balanced
Connectors:	L + R female XLR / TRS Jack; L + R male XLR loop, (Pin2+; 3-; 1 Gnd)
Impedance:	10 kOhm
Input sensitivity:	0.775 V (RMS)
External speaker outputs:	L, R, Sub, 3x Neutrik™ NL4MP
AC Connector:	Neutrik™ PowerCon
AC power requirements:	2800 W peak, 1400 W continuous (max)
LED indicators:	Power on, Signal, 0-dB, LF Limit, Overload
Gain:	-12 dB, 0 dB
Controls:	Volume: Sub, Top L, Top R
Enclosure material:	18 mm Baltic birch
Finish:	Textured black paint
Dimensions:	398 x 454 x 590 mm
Net weight:	31 kg
* Half-space loading	

D-Core2



D-Core2.7

2000 W, containing:

- 1 x Coda PW12A
 - 2 x Coda G308
- (for more information please see page 25)

D-Core2.7 is an ultra compact active sub / sat system for solo-entertainers, duos, unplugged, mobile DJ 's and corporate AV events.



D-Core2.8

2000 W, containing:

- 1 x Coda PW12A
 - 1 x Coda PW12
 - 2 x Coda K289i
- (for more information please see www.codaaudio.com)

D-Core2.8 is an ultra compact active sub / sat system for solo-entertainers, duos, unplugged, mobile DJ 's or corporate AV events.



D-Core2.9

2000 W, containing:

- 1 x Coda PW12A
 - 4-6 x Coda D5-Cube or Coda D5-Tube
- (for more information please see pages 36 and 34)

D-Core2.9 is a distributed installation system for bistros, restaurants, pubs, shopping centres, multimedia, houses of worship, conferences or corporate AV events.



D-Core2.10

2000 W, containing:

- 1 x Coda PW12A
 - 1 x Coda PW12
 - 6-8 x Coda D5-Cube or Coda D5-Tube
- (for more information please see pages 36 and 34)

D-Core2.10 is a distributed installation system for bistros, restaurants, pubs, shopping centres, convention centres, multimedia, houses of worship, conferences or corporate AV events.



PW15A-Pro



PW15A-Pro

Active tri-amp subwoofer including amplifier outlets for stereo tops

- Active tri-amp subwoofer including amplifier outlets for stereo tops
- Coda Audio 15" neodymium ultra low distortion woofer
- 1000 W plus 2 x 500 W class D amplifiers
- Low power compression, superb sound quality
- Optical Limiters for state-of-the-art protection
- Optimized to power the Coda G- and K-Series passive cabinets
- System components: G308, K289i

PW15A is an active tri-amp system subwoofer with amplifier outlets for passive tops containing 2000 W amplification and processing for a complete stereo sub / satellite system.

The electronics: integrates one 1000 W for the low frequency and 2 x 500 W high efficiency class D amplifiers for the top cabinets. The advanced analogue processor includes optical limiters for each channel, 24 dB phase-aligned crossovers, subsonic filters and EQ to provide a perfect match between amplifiers and loudspeakers for optimum acoustic output and reliability.

The use of high efficiency class D amplifier for the subwoofer and for the tops ensures small size, reduced weight and superb sonic performance.

The loudspeaker: 15" high power, long excursion neodymium ultra low distortion woofer providing powerful and extended low frequency response down to 38 Hz. The loudspeaker is 4 Ohm, consuming the whole power of 1000 W from the class D amplifier and therefore cannot drive an additional passive subwoofer. The cabinet incorporates extremely long excursion and a state-of-the-art 15" neodymium driver found only in top of the range concert systems. Optimal output v / s volume.

System integration: Optimized to work together with the G- and K-Series full range passive cabinets, the PW15APro can be connected to diverse mid-high loudspeakers for different applications to build a complete stereo sub / satellite system without the need for additional processing and amplifier racks. Optimal output v / s volume.

Applications: Used in a wide variety of configurations they provide compact and economical plug and play solution for bands, small PA-systems, mobile DJ's or permanent installations.

TECHNICAL SPECIFICATIONS PW15A-Pro

Type:	Active tri-amp subwoofer with amplifier outlets for tops
Application:	Small / medium venues
Frequency response:	38 Hz to 100 Hz
Maximum SPL peak:	132 dB
Amplifier Sub:	Class D
Max. power output (RMS):	1000 W / 4 Ohm
Peak output current:	50 A
THD + N:	0.04% @ 1000 W, 100 Hz, 4 Ohm
Amplifiers Top:	2 x 500 W Class D, 4 Ohm continuous, 2 x 600 W burst
THD + N:	< 0.001 %
Components:	15" neodymium high excursion woofer, 4 Ohm, 4" (101 mm) voice coil, 1200 W (AES)
Crossover:	28 Hz high pass 18 dB, 100 Hz low pass 24 dB, EQ
Input:	Balanced
Connectors:	L + R female XLR / TRS Jacks; L + R male XLR loop (Pin 2+; 3-; 1 Gnd)
Impedance:	10 kOhm
Input sensitivity:	0.775 V (RMS)
External speaker outputs:	L, R, Sub, 3x Neutrik™ NL4MP
AC connector:	Neutrik™ PowerCon
AC power requirements:	2800 W peak, 1400 W continuous (max)
LED Indicators:	Power on, Signal, 0-dB, LF Limit, Overload
Controls:	Volume: Sub, Top L, Top R,
Gain:	-12 dB, 0 dB
Enclosure material:	18 mm Baltic birch
Finish:	Textured black paint
Dimensions:	510 x 454 x 650 mm
Net weight:	36 kg

D-Core5



D-Core5.5

2000 W, containing:

- 1 x Coda PW15A-Pro
 - 2 x Coda G308
- (for more information please see page 25)

D-Core5.5 is a compact sub / sat system for bands, mobile DJ's as well as general PA applications.

D-Core5.6

2000 W, containing:

- 1 x Coda PW15A-Pro
 - 2 x Coda K289i
- (for more information please see www.codaaudio.com)

D-Core5.6 is a compact sub / sat system for bands, mobile DJ's as well as general PA applications.



PW18A-Pro



PW18A-Pro

Active tri-amp subwoofer including amplifier outlets for stereo tops

- Active tri-amp subwoofer including amplifier outlets for stereo tops
- Coda Audio 18" Neodymium ultra low distortion woofer
- 1000 W plus 2 x 500 W class D amplifiers
- Low power compression, superb sound quality
- Optical Limiters for state-of-the-art protection
- Optimized to power the Coda G-Series passive cabinets
- System components: G308, G512-96

PW18A-Pro is an active tri-amp subwoofer with amplifier outlets for passive tops containing 2000 W amplification and processing for a complete stereo Sub / Sat system.

The electronic: integrates one 1000 W high efficiency class D amplifier for the low frequency and 2 x 500 W class D amplifiers for the top cabinets. The advanced analogue processor includes optical limiters for each channel, 24 dB phase-aligned crossovers, subsonic filters, EQ's etc to provide a perfect match between amplifiers and loudspeakers for optimum acoustic output and reliability.

The use of high efficiency class D amplifiers for the subwoofer and for the tops ensures small size, reduced weight and superb sonic performance.

The loudspeaker components: high power high excursion neodymium ultra low distortion woofers provide powerful and extended low frequency response. The incorporated 18" loudspeaker is 4 Ohm, consuming the whole power of 1000 W from the class D amplifier and therefore cannot drive additional passive subwoofers. The cabinet incorporates extremely high excursion, state of the art 18" neodymium driver found only in top of the range concert systems. Optimal output v / s volume.

System integration: Optimized to work together with the G-series full range passive cabinets, the PW18APro active subwoofer can be connected to diverse mid-high loudspeakers for different applications to build a complete stereo Sub/Sat system while replacing multiple 19" audio gear and eliminate the need of external racks.

Applications: Used in a wide variety of configurations they provide compact and economical plug and play solution for bands, small touring PA-systems, mobile DJ's or permanent installations.

TECHNICAL SPECIFICATIONS PW18A-Pro

Type:	Self-powered subwoofer cabinets and satellite amps
Application:	Small / medium venues subwoofer
Frequency response:	30 Hz to 80 Hz
Maximum SPL peak:	131 dB
Amplifier Sub:	Class D
Max. power output (RMS):	1000 W / 4 Ohm
Peak output current:	50 A
THD + N:	0.04% @ 1000 W, 100 Hz, 4 Ohm
Amplifiers Top:	2 x 500 W Class D, 4 Ohm continuous, 2 x 600 W burst
THD + N:	< 0.001%
Components:	18" high excursion woofer 4 Ohm, 4" (101.6 mm) voice coil, 1200 W (AES)
Crossover:	20 hz high pass 18 dB, 100 Hz low pass 24 dB, EQ
Input:	Balanced
Connectors:	L + R female XLR / TRS Jack; L + R male XLR loop (Pin 2 +; 3-; 1 Gnd)
Impedance:	10 kOhm
Input sensitivity:	0.775 V (RMS)
External speaker outputs:	L, R, Sub, 3x Neutrik™ NL4MP
AC connector:	Neutrik™ PowerCon
AC power requirements:	2800 W peak, 1400 W continuous (max)
LED Indicators:	Power on, Signal, 0-dB, LF Limit, Overload
Gain:	-12 dB, 0 dB
Controls:	Volume: Sub, Top L, Top R
Enclosure material:	18 mm Baltic birch
Finish:	Textured black paint
Dimensions:	580 x 624 x 690 mm
Net weight:	51 kg

D-Core8**D-Core8.6**

2000 W, containing:

- 1 x Coda PW18A-Pro
- 2 x Coda G512-96
(for more information please see page 26)

D-Core8.6 is an active compact sub / sat system for bands, mobile DJ's as well as general PA applications.

**D-Core8.7**

2000 W, containing:

- 1 x Coda PW18A-Pro
- 4 x Coda G308
(for more information please see page 25)

D-Core8.7 is a distributed four point system for small clubs, theatres, shopping centres or corporate AV events.



PW-Series



PW-Series self-powered and passive subwoofers

- Compact and powerful
- Neodymium drivers
- Ultra low distortion
- Improved transient response
- Low power compression
- Optimized size/weight to output ratio
- Extreme reliable

Small venues applications

PW100-Series subwoofers: PW112, PW115, PW118. Designed for small installations and portable use the PW100-Series subwoofers combine very well with the G-, D- and K-Series full range systems.

PW100A-Series self-powered subwoofers: PW112A, PW115A and PW118A. Designed for small installations and portable use the PW100A-Series self-powered subwoofers are able to supply an additional passive subwoofer of the PW100-Series, increasing the maximal SPL by up to 6 dB. Very well suited as sub extension to AP8, AP12 and AP15, too.

Small to medium venue

PW200-Series subwoofers: PW215. Designed for small to medium installations and portable use the PW200 series Subwoofers combine very well with D- and K-Series full range systems.

PW200A-Series self-powered subwoofers: PW215A. Designed for small to medium sized installations and portable use the PW200A-Series self-powered subwoofers fit optimal with the AP-Series.

Large venue applications

PW400-Series subwoofers: PW418v². Designed for concert sound applications the PW400 subwoofers combine optimal with the LA-Series.

PW400A-Series self-powered subwoofers: PW418Av². Designed for concert sound applications the PW400A self-powered subwoofers combine perfectly with LA5A line arrays as well as AP20, AP24, AP25 self-powered full range cabinets.

PW112A / PW112

PW112A / PW112

High output subwoofers



- Self-powered high output subwoofer
 - Coda Audio 12" neodymium ultra low distortion woofer
 - 1000 W RMS (2000 W burst) at 4 Ohm Class D amplifier
 - Capable of driving an additional passive subwoofer (PW112)
 - Low power compression, superb quality sound
 - Optical Limiter for state-of-the-art protection
 - Integrated 24 dB high pass crossover output for mid / high bands
- System components PW112: Coda Audio System Amplifier, Coda Audio System Controller, D5-Tube, D5-Ceiling, D5-Cube, K4, K5, PW112A
System components PW112A: Coda Audio System Controller, AP8, PW112

The PW112A is a compact self-powered high output subwoofer incorporating a 1000 W high efficiency class D amplifier. The integrated control electronics include an optical limiter, 24 dB phase-aligned crossovers and EQ to provide a perfect match between amplifier and loudspeaker for optimum acoustic output and reliability. The incorporated high pass crossover output (80 Hz or 125 Hz) enables easy integration of top cabinets without additional external processing.

The high power 12" neodymium woofer provides powerful and extended low frequency response with immense head-room. An integrated speaker output enables the use of an additional passive subwoofer (PW112), providing an economical solution to increase the system maximal level to 135 dB / peak. The use of high efficiency class D amplifier together with the newly developed neodymium ultra low distortion woofer ensures small size, reduced weight and superb sonic performance.

Applications include small touring PA-systems or permanent installations.

TECHNICAL SPECIFICATIONS PW112	
Power handling RMS:	600 W
Program power:	1200 W
Peak power:	2400 W
Sensitivity:	96 dB, 1 W / 1 m
Nominal impedance:	8 Ohm
Input connectors:	2 x Neutrik™ NL4MP
Dimensions:	450 x 394 x 530 mm
Net weight:	23 kg
Same as the PW112A without the amplifier.	

TECHNICAL SPECIFICATIONS PW112A	
Type:	Self-powered subwoofer
Application:	Small / medium venues subwoofer
Frequency response:	35 Hz to 80 Hz or 125 Hz (switchable)
Maximum SPL peak:	129 dB single cabinet, 135 dB (PW112A + PW112 as slave)
Amplifier:	Class D
Max. power output (RMS):	1000 W / 4 Ohm
Peak output current:	50 A
THD + N:	0.04% @ 1000 W, 100 Hz, 4 Ohm
Components:	12" neodymium ultra low distortion woofer, 8 Ohm, 3" (77 mm) voice coil, 600 W (AES)
Crossover:	30 Hz high pass 18 dB, 80 Hz or 150 Hz low pass 24 dB, EQ
Input:	Balanced
Connectors:	1 x female XLR / TRS Jack; 1 x male XLR loop; 1 x male XLR top -24 dB high pass output @ 80 Hz or 125 Hz (Pin 2+; 3-; 1 Gnd)
Impedance:	10 kOhm
Input sensitivity:	0.775 V (RMS)
External speaker output:	Neutrik™ NL4MP (8 Ohm only)
AC connector:	Neutrik™ PowerCon
AC power requirements:	2000 W peak, 1000 W continuous (max)
LED indicators:	Power on, Signal, 0-dB, LF limit, Overload
Gain:	-12 dB, 0 dB
Controls:	2 x high / low pass filters
Suspension:	Optional
Enclosure material:	18 mm Baltic birch
Finish:	Textured black paint
Dimensions:	450 x 394 x 530 mm
Net weight:	31 kg



PW115A / PW115



PW115A / PW115

High output subwoofer

- Self-powered high output subwoofer
 - Coda Audio 15" neodymium ultra low distortion woofer
 - 1000 W RMS (2000 W burst) at 4 Ohm Class D amplifier
 - Capable of driving an additional passive woofer (PW115)
 - Low power compression, superb sound quality
 - Optical Limiter for state-of-the-art protection
 - Improved transient response
 - Integrated 24 dB high pass crossover output for mid / high bands
- System components PW115: Coda Audio System Amplifier, Coda Audio System Controller, D8, PW115A
 System components PW115A: Coda Audio System Controller, AP12, AP15, PW115

The PW115A is a compact self-powered high output subwoofer incorporating a 1000 W high efficiency class D am-

plifier. The integrated control electronics include an optical limiter, 24 dB phase-aligned crossovers and EQ to provide a perfect match between amplifier and loudspeaker for optimum acoustic output and reliability. The incorporated high pass crossover output (80 Hz or 125 Hz) enables easy integration of top cabinets without additional external processing.

The high power 15" neodymium woofer provides powerful and extended low frequency response with immense headroom. An integrated speaker output enables the use of an additional passive subwoofer (PW115) providing an economical solution to increase the system maximal level to 137 dB / peak.

The use of high efficiency class D amplifier together with the newly developed neodymium ultra low distortion woofer ensures small size, reduced weight and superb sonic performance.

Applications include small touring PA-systems or permanent installations.

TECHNICAL SPECIFICATIONS PW115A	
Type:	Self-powered subwoofer
Application:	Small / medium venues subwoofer
Frequency response:	38 Hz to 80 Hz or 125 Hz (switchable)
Maximum SPL peak:	131 dB single cabinet or 137 dB (PW115A + PW115 as slave)
Amplifier:	Class D
Max. power output (RMS):	1000 W / 4 Ohm
Peak output current:	50 A
THD + N:	0.04% @ 1000 W, 100 Hz, 4 Ohm
Components:	15" neodymium ultra low distortion woofer, 8 Ohm, 3" (77 mm) voice coil, 600 W (AES)
Crossover:	30 Hz high pass 18 dB, 80 Hz or 150 Hz low pass 24 dB, EQ
Input:	Balanced
Connectors:	1 x female XLR / TRS Jack; 1 x male XLR loop; 1 x male XLR top -24 dB high pass output @ 80 Hz or 125 Hz (Pin2+; 3-; 1 Gnd)
Impedance:	10 kOhm
Input sensitivity:	0.775 V (RMS)
External speaker output:	Neutrik™ NL4MP (8 Ohm only)
AC connector:	Neutrik™ PowerCon
AC power requirements:	2000 W peak, 1000 W continuous (max)
LED indicators:	Power on, Signal, 0-dB, LF limit, Overload
Gain:	-12 dB, 0 dB
Controls:	2 x high / low pass filters
Suspension:	Optional
Enclosure material:	18 mm Baltic birch
Finish:	Textured black paint
Dimensions:	450 x 484 x 600 mm
Net weight:	34 kg

TECHNICAL SPECIFICATIONS PW115	
Power handling RMS	600 W
Program power:	1200 W
Peak power:	2400 W
Sensitivity:	98 dB, 1 W / 1 m
Nominal impedance:	8 Ohm
Input connectors:	2 x Neutrik™ NL4MP
Dimensions:	450 x 484 x 600 mm
Net weight:	24 kg
Same as the PW115A without the amplifier.	

PW118A / PW118

PW118A / PW118

High output subwoofers



- Self-powered high output subwoofer
 - Coda Audio 18" high excursion woofer
 - 1000 W RMS (2000 W burst) at 4 Ohm Class D amplifier
 - Capable of driving an additional passive woofer (PW118)
 - Low power compression, superb sound quality
 - Optical Limiter for state-of-the-art protection
 - Integrated 24 dB high pass crossover output for mid / high bands
- System components PW118: Coda Audio System Amplifier, Coda Audio System Controller, D8, PW118A
System components PW118A: Coda Audio System Controller, AP12, AP15, AP20, AP24, AP25, PW118

The PW118A is a compact self-powered high output subwoofer incorporating a 1000 W high efficiency class D amplifier. The integrated control electronics include an optical limiter, 24 dB phase-aligned crossovers and EQ to provide a perfect match between amplifier and loudspeaker for optimum acoustic output and reliability. The incorporated high pass crossover output (80 Hz or 125 Hz) enables easy integration of top cabinets without additional external processing.

The high power long excursion 18" woofer provides powerful and extended low frequency response with immense headroom. An integrated speaker output enables the use of an additional passive subwoofer providing an economical solution to increase the system maximal level to 137 dB / peak. The use of high efficiency class D amplifier ensures small size, reduced weight and superb sonic performance.

Applications include small touring PA-systems or permanent installations.

TECHNICAL SPECIFICATIONS PW118	
Power handling RMS:	1000 W
Program power:	2000 W
Peak power:	4000 W
Sensitivity:	98 dB, 1 W / 1 m
Nominal impedance:	8 Ohm
Input connectors:	2 x Neutrik™ NL4MP
Dimensions:	580 x 624 x 690 mm
Net weight:	39 kg
Same as the PW118A without the amplifier.	

TECHNICAL SPECIFICATIONS PW118A	
Type:	Self-powered subwoofer
Application:	Medium / large venues subwoofer
Frequency response:	38 Hz to 80 Hz or 125 Hz (switchable)
Maximum SPL peak:	131 dB single cabinet, 137 dB (PW118A + PW118 as slave)
Amplifier:	Class D
Max power output (RMS):	1000 W / 4 Ohm
Peak output current:	50 A
THD + N:	0.04% @ 1000 W, 100 Hz, 4 Ohm
Components:	18" neodymium high excursion woofer, 8 Ohm, 4" (101.6 mm) voice coil, 1100 W (AES)
Crossover:	30 Hz high pass 18 dB, 80 Hz or 125 Hz low pass 24 dB, EQ
Input:	Balanced
Connectors:	1 x female XLR / TRS Jack; 1 x male XLR loop; 1 x male XLR top -24 dB high pass output @ 80 Hz or 125 Hz (Pin 2 +; 3-; 1 Gnd)
Impedance:	10 kOhm
Input sensitivity:	0.775 V (RMS)
External speaker output:	Neutrik™ NL4MP (8 Ohm only)
AC connector:	Neutrik™ PowerCon
AC power requirements:	2000 W peak, 1000 W continuous (max)
LED indicators:	Power on, Signal, 0-dB, LF limit, Overload
Gain:	-12 dB, 0 dB
Controls:	2 x high / low pass filters
Suspension:	Optional
Enclosure material:	18 mm Baltic birch
Finish:	Textured black paint +
Dimensions:	580 x 624 x 690 mm
Net weight:	46 kg

PW215A / PW215



PW215A / PW215

High output subwoofer

- Self-powered high output subwoofer
- Coda Audio Double 15" ultra low distortion woofer
- 1000 W RMS (2000 W burst) Class D amplifier
- Low power compression, superb sound quality
- Optical Limiter for state-of-the-art protection
- Improved transient response
- Integrated 24 dB high pass crossover output for mid / high bands
- System components Coda Audio System Amplifier, Coda Audio System Controller
- System components PW215A: Coda Audio System Controller, AP15, AP20, AP24, AP25

The PW215A is a compact self-powered high output subwoofer incorporating a 1000 W high efficiency class D amplifier.

The integrated control electronics include an optical limiter, 24 dB phase-aligned crossovers and EQ to provide a perfect match between amplifier and loudspeakers for optimum acoustic output and reliability.

The incorporated high pass crossover output (80 Hz or 125 Hz) enables easy integration of the top cabinets without additional external processing. The high power long excursion dual 15" woofers provide powerful and extended low frequency response with immense headroom.

The use of high efficiency class D amplifier ensures small size, reduced weight and superb sonic performance. Low port compression and optimized enclosure design give a tight, accurate bass response that is ideally suited to supplementing all Coda Audio full range enclosures.

Applications include bands, touring PA-systems or permanent installations.

TECHNICAL SPECIFICATIONS PW215A

Type:	Self-powered subwoofer
Application:	Medium / large venues subwoofer
Frequency response:	40 Hz to 80 Hz or 125 Hz (switchable)
Maximum SPL peak:	137 dB
Amplifier:	Class D
Max power output (RMS):	1000 W / 4 Ohm
Peak output current:	50 A
THD +N:	0.04% @ 1000 W, 100 Hz, 4 Ohm
Components:	2 x 15" ultra low distortion woofers, 8 Ohm, 3" (77 mm) voice coil, 600 W (AES) each
Crossover:	30 Hz high pass 18 dB, 80 Hz or 150 Hz low pass 24 dB, EQ
Input:	Balanced
Connectors:	1 x female XLR / TRS Jack; 1 x male XLR loop; 1 x male XLR top -24 dB high pass output @ 80 Hz or 125 Hz (Pin 2+; 3-; 1 Gnd)
Impedance:	10 kOhm
Input sensitivity:	0.775 V (RMS)
External speaker output:	Neutrik™ NL4MP (8 Ohm only)
AC connector:	Neutrik™ PowerCon
AC power requirements:	2000 W peak, 1000 W continuous (max)
LED indicators:	Power on, Signal, 0-dB, LF limit, Overload
Gain:	-12 dB, 0 dB
Controls:	2 x high / low pass filters
Suspension:	Optional
Enclosure material:	18 mm Baltic birch
Finish:	Textured black paint+
Dimensions:	450 x 944 x 690 mm
Net weight:	59 kg

TECHNICAL SPECIFICATIONS PW215

Power handling RMS:	1200 W
Program power:	2400 W
Peak power:	4800 W
Sensitivity:	101 dB, 1 W / 1 m
Nominal impedance:	4 Ohm
Input connectors:	2 x Neutrik™ NL4MP
Dimensions:	450 x 944 x 690 mm
Net weight:	50.5 kg
Same as the PW215A without the amplifier.	

PW418Av² / PW418v²PW418Av² / PW418v²

High output double 18" subwoofer



- High output subwoofer
 - Double Coda Audio 18" neodymium ultra low distortion woofers
 - Linear frequency response down to 28 Hz
 - Maximum SPL 145 dB (peak)
 - Low power compression
- System components PW418v²: Coda Audio System Amplifier, Coda Audio System Controller, LA4, LA4-SUB
System components PW418Av² : Coda Audio System Controller, LA5A, LA5A-SUB, AP15, AP20, AP24, AP25

The PW418v² is a double 18" high output subwoofer that provides powerful and extended low frequency response with immense head-room. Low port compression and optimized enclosure design give a tight, accurate bass response that is ideally suited for touring, dance clubs and large installations.

State of the art drivers

The PW418 is equipped with twin extremely long excursion 18" neodymium ultra low distortion woofers. The neodymium motor delivers extreme high magnetic flux for increased efficiency. The 4" voice coil is 38 mm high, ensuring ultra linear excursion of 26 mm / pp at consistent magnetic force. State-of-the-art carbon-fiber cone ensures maximum stiffness and low moving mass. Three aluminum shorting rings reduce intermodulation distortion, minimize induction variation while reducing thermal compression. This design dramatically re-

duces the distortion of a typical subwoofer at longer excursion levels, and improves the overall sound quality and performance characteristics of the cabinet.

Applications: The PW418v² is perfectly suited for use in arenas, houses of worship, theatres, clubs and open airs.

TECHNICAL SPECIFICATIONS PW418v ²	
Type:	2 x 18" subwoofer
Application:	High output subwoofer
Frequency response (-6 dB):	28 Hz to 120 Hz
Power handling (AES / Peak):	2500 W / 10000 W
Sensitivity 1 W / 1 m:1	105 dB
Maximum output peak:2	145 dB
Components:	2 x 18" ultra low distortion neodymium woofers, 4" (101.6 mm) voice coil, 1250 W (AES) each
Nominal impedance:	4 Ohm, +1 / -1
Input connectors:	2 x Neutrik™ NL4MP
Suspension:	Optional
Enclosure material:	18 mm Baltic birch
Finish:	Textured black Paint
Dimensions:	1164 x 584 x 780 mm
Net weight:	85 kg
1 Half space loading	
2Measured with pink noise 6 dB crest factor	

TECHNICAL SPECIFICATIONS PW418Av ²	
Type:	Self-powered subwoofer
Application:	Medium / large venues subwoofer
Frequency response:	28 Hz to 80 Hz or 125 Hz (switchable)
Maximum SPL peak:	145 dB
Amplifier:	Class D
Max. power output (RMS):	2 x 1000 W / 4 Ohm
Peak output current:	50 A
THD + N:	0.04% @ 1000 W, 100 Hz, 4 Ohm
Components:	2 x 18" ultra low distortion neodymium woofers, 4 Ohm, 4" (101.6 mm) voice coil, 1250 W (AES) each
Crossover:	20 Hz high pass 18 dB, 80 Hz or 150 Hz low pass 24 dB, EQ
Input:	Balanced
Connectors:	1 x female XLR / JTS Jack; 1 x male XLR loop; 1 x male XLR top -24 dB high pass output @ 80 Hz or 125 Hz (Pin 2+; 3-; 1 Gnd)
Impedance:	10 kOhm
Input sensitivity:	0.775 V (RMS)
External speaker output:	Neutrik™ NL4MP (8 Ohm only)
AC connector:	Neutrik™ PowerCon
AC power requirements:	4000 W peak, 2000 W continuous (max)
LED indicators:	Power on, Signal, 0-dB, LF limit, Overload
Gain:	-12 dB, 0 dB
Controls:	2 x high / low pass filters
Suspension:	Optional
Enclosure material:	18 mm Baltic birch
Finish:	Textured black paint
Dimensions:	1164 x 584 x 780 mm
Net weight:	98 kg

DNC260 / DNC260N



DNC260 / DNC260N

Digital system controller

- Two balanced inputs and six balanced outputs
- High quality 96 kHz audio processing
- Easy to use

Key Features

The Coda Audio DNC260 System Controller is a high performance, easy to use signal processor containing presets for all Coda Audio loudspeaker systems. The DNC260 provides generous amounts of signal processing capability and is complemented by a highly flexible parameter arrangement ideally suited to touring and installation applications.

The DNC260 may be controlled just as comprehensively from its front panel, or by using the C-Net software application. C-Net software can operate a single DNC260, or can optionally control a multi-km network of products using the optional C-NET network (DNC260N).

TECHNICAL SPECIFICATIONS DNC260 / DNC260N	
Input impedance:	10 Ohm balanced
Output Imp:	100 R Gnd balanced
Max Input level:	+20 dBu
Max Output level:	+20 dBu into 600 R
Sample rate:	96 kHz
Frequency Response:	20 Hz - 20 kHz + / - 0.5 dB 10Hz - 40 kHz + / - 3 dB
Dynamic range:	112 dB (A weighted, 22 kHz bandwidth)
THD (20Hz-20 Hz):	0.008% Typ Connectors
Audio Inputs:	3 pin female XLR
Audio Outputs:	3 pin male XLR
Serial comms:	RS232 port via 9 pin female D
Network comms:	only DNC260N
Mains:	3 pin IEC
Mains Power:	Universal switch-mode PSU, 85 V to 250 A AC, 50 / 60 Hz
Power consumption:	25 W max
Dimensions:	482 x 44 x 185 mm 19" x 1.8" x 7.3"
Weight:	2.7 kg net
Options:	Network card (included in DNC260N)

- Factory presets for all Coda Audio Systems
- Customer presets
- PC control
- C-NET networking option

Sonic Purity

The DNC260 uses 96Hz sampling rate, Burr-Brown analogue-to-digital converter, Wolfson multi-bit digital-to-analogue converter, and a powerful generation Sharc Digital signal Processor. All this adds up to deliver the ultimate in sonic transparency and a stunning open natural sound quality.

Factory Presets

The DNC260 has complementary preset library for all Coda Audio loudspeaker systems. Presets are stored permanently.

User Presets

The user cannot access or overwrite the factory presets but can effectively overlay the factory settings using master EQs to match different acoustic environments or apply delay for time alignment or change gains to create and save their own variants.

PARAMETER RANGES	
Input Gain	-80 to +20dB
Input Delay	0 to 405ms
Input HPF Freq.	20Hz to 25 Hz
Input HPF shapes	1st order, Bes12, But12, LR12, Bes18, But18, Bes24, But24, LR24, Hardman4th
Output Gain	-80 to +20dB
Output Polarity	Norm, Invert
Output Delay	0 to 80ms
Para EQ Freq	10Hz to 25 Hz
Para EQ Width	0.1 to 5.2 Oct Q 0.2 to 14.2
Para EQ Gain	-15 to +15dB
Para EQ Slope	6 to 12dB
Shelf EQ Freq	10Hz to 25 Hz
Shelf EQ Gain	-15 to +15dB

C3

C3

2-channel DSP amplifier, 2500W



- 2 x 1250W@2 Ohm or 1 x 2500W@4 Ohm
- 2 Ohm and 70V / 100V line capability
- 2-input, 2-output, 96 kHz DSP with real-time monitoring
- Extremely rugged with abuse logging

- C-Net network control and monitoring of amplifiers and loudspeaker loads
- Factory presets for Coda Audio G-Series, D-Series, CUE monitors, LA4 and CoRAY4 systems

The Coda Audio C3 is a 19"/2U high performance, cost effective 2 channel power amplifier integrating light-weight power supplies, high power class D amplifiers and USB or network controlled 24 bit 96kHz extremely powerful state-of-the-art SHARC based DSP. The C-Net network allows remote control of DSP parameter such as delays, EQs, groups etc, as well as completes monitoring of amplifier conditions and loudspeaker loads.

C3 also has the capability to recall up to four different sets of settings by the means of rear panel contact closure inputs. This can be particularly important in voice evacuation applications where, for example, it may be required to mute the current source of audio, switch to an alternate input carrying an evacuation message and broadcast it with different level and EQ settings. Each pair of C3 channels can automatically do this either independently or collectively. Factory presets for Coda Audio G-Series, D-Series, CUE monitors, LA4 and CoRAY4 systems provide optimal power solution for wide range of fixed installation applications.

ACCESSORIES

Airflow filtering kit
Rear rack support kit

TECHNICAL SPECIFICATIONS C3

AMPLIFIERS

Type:	High efficiency class D
Number of channels:	Two
Output power:	(RMS program, 20Hz-20kHz all channels driven)
per channel:	2x 1,250W in to 2 Ohms 2x 800W in to 4 Ohms 2x 450W in to 8 Ohms
per bridged pair:	1x 2,500W in to 4 Ohms 1x 1,600W in to 8 Ohms 1x 900W in to 16 Ohms
Slew rate:	> 80V/us
Damping factor:	120 ref 8 Ohms
Efficiency:	> 90% typical

AUDIO SPECIFICATIONS

Input impedance:	10k balanced
Max Input level:	+20dBu
Frequency Response:	20Hz - 20kHz +/-0.5dB @ 4 Ohm load
Output noise:	-106dB A weighted Ref max output, 22kHz BW
Distortion	< 0.05% (1kHz, -3dB output, 22kHz BW)

PROTECTION SYSTEMS

Output over current:	Initially gain reduced to maintain control, extreme or persistent over current causes shutdown
Over temperature:	limiters applied, persistent over temperature causes shutdown
Mains Brownout:	Automatic protection & recovery
Switch on surge:	Soft-start current inrush limiting
DC on output:	Immediate shutdown, power cycle to recover

C3



TECHNICAL SPECIFICATIONS C3

THERMAL

Two variable speed fans

INDICATORS & CONTROLS

Indicators per channel: Sig, Limit -6dB, Limit
 Indicators per channel pair: Power, Protect, Bridge, Network, User DSP active
 Front panel controls:
 Per channel pair: User DSP Defeat - can be disabled with C-Net
 Power switch

Rear panel:

Per channel pair: Contact closure inputs and Shutdown input (Aux)
 Monitoring facilities: Input signal level, Output signal level
 Output current level
 Temperature
 Limiter operation
 Protection system operation
 Driver impedance

POWER SUPPLIES

Type: High current, high freq. switch-mode
 Number: One / Two, fully independent
 Efficiency: > 90% typical
 Input voltage: 115v / 230v nominal +/- 10%
 * for 100v operation output figures please see separate specifications
 Input voltage selection: Automatic
 Mains frequency range: 45 - 65Hz
 Other features: Automatic soft-start
 Automatic brownout recovery
 Remote shutdown
 Automatic over voltage protection

TECHNICAL SPECIFICATIONS C3

CONNECTIONS

Mains (per C3): Neutrik „Powercon“
 Audio input (per channel): 3 pin female XLR
 Audio link (per channel): 3 pin male XLR
 Output (per channel): Neutrik NL4 „Speakon“
 USB: Type B (peripheral type)
 Network (input & link): 2x RJ45 socket
 Auxiliary (input & link): 2x RJ45 socket

Recommended minimum operating voltage

230V range 155V
 115V range 80V

Note that the range is automatically selected.

PHYSICAL

Height: 2RU, 88mm
 Width: 19", 482mm (front panel)
 16.8", 427mm (rear chassis)
 Depth: 14", 360mm (behind rack)
 1.4", 35mm (forward of rack)
 Net weight: 8 kg
 Operating temperature range: 0 to +40°C
 Relative humidity range: 0 to 80% (non-condensing)

C5

C5

4-channel DSP amplifier, 5000 W



- Integrated DSP, network and amplifier solution
- 4x 1250W@2 Ohm or 2x 2500W@4 Ohm
- 2 Ohm and 70 V / 100 V Line Capability
- 4 –input, 4 – output, 96 kHz DSP with real-time monitoring

- Extremely rugged with abuse logging
- C-Net network control and monitoring of amplifiers and loudspeaker loads
- Factory presets for Coda Audio G-Series, D-Series, CUE monitors, LA4 and CoRAY4 systems

The Coda Audio C5 is a 19"/2U high performance, cost effective four channel power amplifier integrating light-weight power supplies, high power class D amplifiers and USB or network controlled 24 bit 96 kHz extremely powerful state-of-the-art SHARC based DSP. The C-Net network allows remote control of DSP parameter such as delays, EQs, groups etc, as well as complete monitoring of amplifier conditions and loudspeaker loads.

The C5 also has the capability to recall up to four different sets of settings by the means of rear panel contact closure inputs.

This can be particularly important in voice evacuation applications where, for example, it may be required to mute the current source of audio, switch to an alternate input carrying an evacuation message and broadcast it with different level and EQ settings. Each pair of C5 channels can automatically do this either independently or collectively. Factory presets for Coda Audio G-Series, D-Series, CUE monitors, LA4 and CoRAY4 systems provide optimal power solution for wide range of fixed installation applications.

ACCESSORIES

Rear rack support kit
C-Net Interface

TECHNICAL SPECIFICATIONS C5

AMPLIFIERS

Type:	High efficiency class D
Number of channels:	Four
Output power 4 channels (RMS program, 20Hz-20kHz all channels driven):	
	4 x 1250W in to 2 Ohms
	4 x 800W in to 4 Ohms
	4 x 450W in to 8 Ohms
Output power 2 bridged channels (RMS program, 20Hz-20kHz all channels driven) per bridged pair:	
	2 x 2500W in to 4 Ohms
	2 x 1600W in to 8 Ohms
	2 x 900W in to 16 Ohms
Output power 3 channels (RMS program, 20Hz-20kHz all channels driven):	
	2 x 1250W@2 Ohms + 2500W@4 Ohms
	2 x 800W@4 Ohms + 2500W@4 Ohms
	2 x 450W@8 Ohms + 1250W@8 Ohms
Slew rate:	> 80V/us
Damping factor:	120 ref 8 Ohms
Efficiency:	> 90% typical

DSP

Sampling rate:	96 kHz
AD Convertors:	Burr-Brown
DA Convertors:	Wolfson
Processor:	Sharc
Remote network:	C-Net

C5



TECHNICAL SPECIFICATIONS C5

AUDIO SPECIFICATIONS

Input impedance:	10k balanced
Max Input level:	+20dBu
Frequency Response:	20Hz - 20kHz +/-0.5dB 4 Ohm load
Output noise:	-106dB A weighted, Ref max output, 22kHz BW
Distortion:	<0.05% (1kHz, -3dB output, 22kHz BW)

PROTECTION SYSTEMS

Output over current:	Initially gain reduced to maintain control, persistent over current causes shutdown
Over temperature:	limiters applied, persistent over temperature causes shutdown
Mains Brownout:	Automatic protection & recovery
Switch on surge:	Soft-start current inrush limiting
DC on output:	Immediate shutdown, power cycle to recover

THERMAL

One variable speed fan per pair of channels and additionally one variable speed fan per unit
Airflow is from the rear to the front

INDICATORS & CONTROLS

Per channel:	Sig, Limit -6dB, Limit
Per channel pair:	Power, Protect, Bridge, Network, User DSP active
Controls per channel pair:	
Front panel:	User DSP defeat (can be disabled with C-Net) Power switch
Rear panel:	Two contact closure inputs, shutdown input
Monitoring facilities:	Input signal level, output signal level Output current level, temperature, limiter operation Protection system operation, driver impedance

TECHNICAL SPECIFICATIONS C5

POWER SUPPLIES

Type:	High current, high freq. switchmode
Number:	Two, fully independent
Efficiency:	>90% typical
Input voltage:	100V* / 115V / 230V nominal +/- 10% (*for 100V operation please see separate specifications)
Input voltage selection:	Automatic
Mains frequency range:	45 - 65Hz
Other features:	Automatic soft-start, automatic brownout recovery Remote shutdown, automatic over voltage protection

CONNECTIONS

Mains:	Neutrik 'Powercon'
Audio input (per channel):	3 pin female XLR
Audio link (per channel):	3 pin male XLR
Output (per channel):	Neutrik NL4 'Speakon'
USB:	Type B (peripheral type)
Network (input & link):	2x RJ45 socket
Auxiliary (input & link):	2x RJ45 socket

PHYSICAL

Height:	2RU, 88 mm
Width:	19", 482 mm (front panel) 16.8", 427 mm (rear chassis)
Depth:	14", 360 mm (behind rack) 1.4", 35 mm (forward of rack)
Weight:	9 kg (20lbs)
Operating temperature range:	0 to +40°C
Relative humidity range:	0 to 80% (non-condensing)

CODA

C O D A A U D I O



Coda Audio
Boulevard der EU 6
30539 Hannover, Expo Park
Germany
Phone: +49 (0)511- 866 558 88
Fax: +49 (0)511- 866 558 87
E-Mail: contact@codaaudio.com
Website: www.codaaudio.com